

NW COR. SEC. 11-34-11E  
EXISTING 1" IRON PIPE

### SURVEY OF PART OF SECTION 11, TOWNSHIP 34 NORTH, RANGE 11 EAST, TOWN OF ELCHO, LANGLADE COUNTY

PREPARED BY:  
NORTHWOODS SURVEYING  
623 JEFFERSON STREET  
WAUSAU, WI. 54403  
715-845-1249

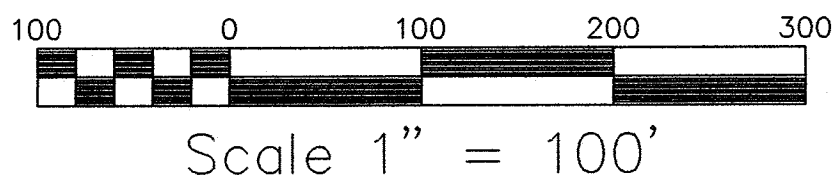
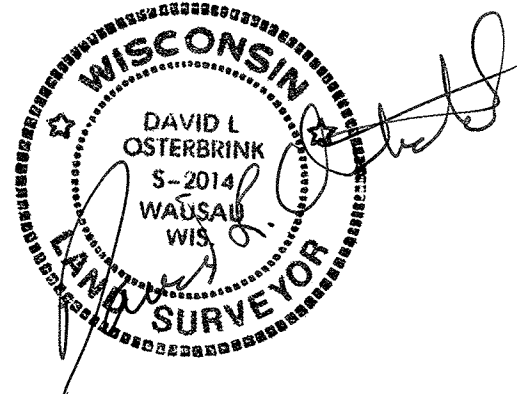

RECORD # 40299  
LANGLADE COUNTY SURVEYORS OFFICE  
DATE FILED: 3/6/99 BY: DAVE LUSTY

N04°14'26"E  
2675.94'

N01°24'22"E  
2692.99'

- ◆ EXISTING AXEL SHAFT
- EXISTING SQUARE HEADED BOLT
- EXISTING 2" IRON PIPE
- ⊗ EXISTING BRASS CAPPED 2" IRON PIPE
- EXISTING 1-1/4" IRON PIPE
- EXISTING 3/4" IRON PIPE
- SET 1-1/4" x 24" IRON PIPE WEIGHING 2.27 LBS / LIN. FT.

PRATT ROAD

SET IRONS 33' EAST OF EXISTING CENTER LINE

140

140

WEST SHORE DRIVE

POST LAKE

600'

N4°15'50"E 599.78'

WEST 1/4 COR. SEC. 11-34-11E  
EX. RAIL ROAD SPIKE

EAST - WEST 1/4 LINE BY COUNTY SURVEYORS SUBDIVISION  
S88°54'08"E

BILL KELLY MC (INCORRECT)

PROBABLE IRON SET BY KIRBY, 8- 1959-  
MAP # 30437  
FROM NEW W 1/4 S88°53'27"E 1791.31'  
0.36' SOUTH OF COUNTY SURVEYORS E-W 1/4 LINE  
FROM OLD W 1/4 S88°15'53"E 1923.61' (1924.9' RECORD)