

N 1/4 corner
Alum Mon. fd.

S 89°30'24" W 2655.70'

S 89°21'25" E 2652.61'

N 1/4 corner, Sec. 32
RR spk. fd.

NE corner, Sec. 31
Alum Mon. fd.

N 01°57'01" E 491.12'

N 88°39'10" W 908.82'

N 34°30'19" W 679.07'

69.023 Acres

334.66'

N 88°54'08" W

DNR easement along road
N 61°28'53" W 609.92'

160.22' S 88°14'46" W
N 77°59'41" W

168.13'

N 2°09'09" E 2636.79'

N 86°38'20" E 1133.75'

170.24'
N 70°32'18" E

N 49°02'47" E

S 89°41'57" E 2652.08'

S 89°41'57" E 1466.41'

1326.04'

1185.67'

N 2°11'59" E 2605.19'

2197.85'

N 01°22'29" W

centerline C.T.H.

centerline C.T.H.

centerline C.T.H.

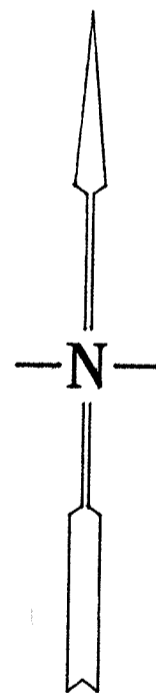

SCALE: 1" = 200'
0' 100' 200' 400'

LEGEND

- Iron pipe set
- Iron pipe found
- ⊠ Aluminum monument found
- Boundary of parcel surveyed

E 1/4 corner
Sec. 31
Cor. for ties. Plowed field.

1026.71'

291.69'

1318.39'

N 02°09'09" E 1318.39'

S 02°02'27" E 1318.39'

wood post cor.

S W - N W

S E - N E

N W - N W

N E - N E

S W - N W

N E - N W

5.911 Ac.

N 00°02'27" W

33.00'

N 47°39'11" E 455.95'

351.56'

N 39°06'41" E

246.45'

87.88'

S 78°49'01" E

84.11'

N 2°11'59" E

109.37'

374.31'

407.34'

N 2°11'59" E

35.03'

789.68'

S 89°57'33" W 788.39'

2575.91'

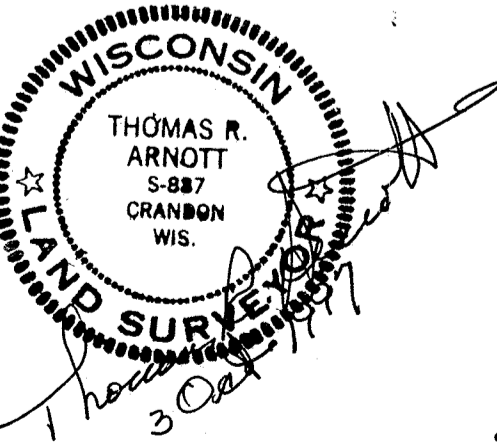

S 1/4 corner
GLO mon. fd.

C 1/4 corner
IP fd.

E 1/4 corner
IP fd.

N 2°11'59" E

2605.19'

N 2°11'59" E

2605.19'

N 2°11'59" E

2605.19'

N 2°11'59" E

2605.19'

N 2°11'59" E

2605.19'

N 2°11'59" E

2605.19'

N 2°11'59" E

N 2°11'59" E

RECORD # 40213

LANGLADE COUNTY SURVEYORS OFFICE

DATE FILED: BY:

THOMAS R. ARNOTT REGISTERED LAND SURVEYOR P.O. BOX 635 ANTIGO, WIS. 54409	
Survey for Diercks & Sons, Inc. Part of Sections 31 & 32, T. 31 N., R. 14 E., Town of Wolf River, Langlade County, WI.	
SCALE: 1" = 200'	DATE: 14 August, 1997 Revised 2, Oct. 1997
DC FILE: TADEK331	