

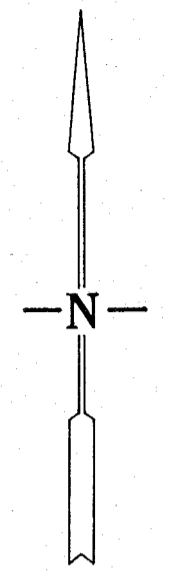

A = 13°00'39"
 R = 605.96'
 Chd = N 2°43'52" W
 137.30'



SCALE: 1" = 100'
 0 50' 100' 200'

LEGEND

- iron pipe set
- iron pipe found
- ⊙ county mon. found
- △ RR spike found
- Boundary of parcel surveyed.

Bearings referenced to section lines shown.
 Section subdivision information used for this survey has been filed in the County Surveyors records.

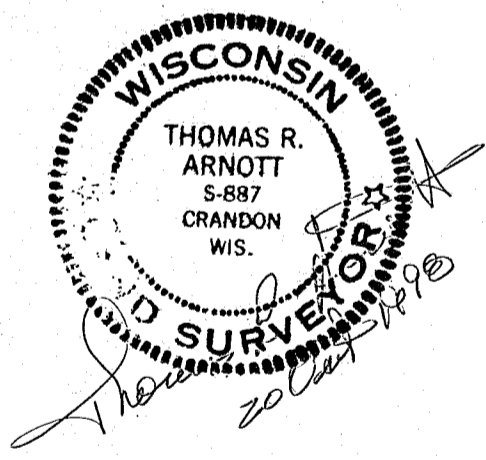

STRAIGHTLINE SURVEYING, INC. W2983 SOUTH LAKE LANE WHITE LAKE, WI 54491	
MAP OF SURVEY FOR ED SELLERS PART OF THE NW 1/4 OF THE NW 1/4 OF SECTION 16, T. 31 N., R. 14 E., TOWN OF WOLF RIVER, LANGLADE COUNTY, WISCONSIN.	
SCALE: 1" = 125'	DATE: 17 OCT., 1998
DC FILE: EDSSELLER	

RECORD # 30505
 LANGLADE COUNTY SURVEYORS OFFICE
 DATE FILED: _____ BY: _____