

A parcel of land located in the SW 1/4 NW 1/4, Sect. 2, T31N, R12E, described as follows:

Commencing at the NW corner of said Sect. 2; thence S02°44'35"W, 1066.05 feet to the 1/8 corner; thence S89°15'49"E, 33.02 feet to the point of beginning;

Thence S89°15'49"E, 1000.00 feet; thence S02°44'35"W, 440.00 feet; thence N89°15'49"W, 1000.00 feet; thence N02°44'35"E, 440.00 feet to the point of beginning.

Said parcel contains 10.1 acres.

# MAP OF SURVEY

FOR: JAMES YANNOY

LOCATED IN THE SW 1/4 NW 1/4, SECT. 2, T31N, R12E  
TOWN OF POLAR, LANGLADE COUNTY, WISCONSIN

**LEGEND:**

- 1" x 30" IRON PIPE, SET, MIN. WT. 113#/LF
- △ NAIL, SET OVER EXISTING AXLE IN ROAD
- ⊕ BRASS CAP MONUMENT, FOUND IN PLACE
- ⊕ 3" ALUM. CAP MONUMENT, SET
- RR SPIKE AND WITNESS MONUMENTS, SET

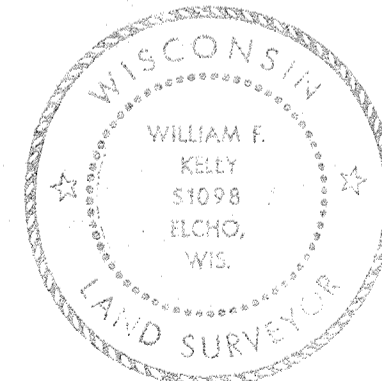

William E. Kelly  
12-31-87

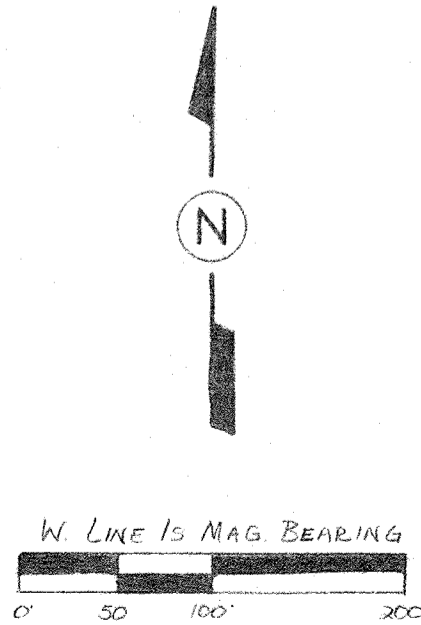

BUILDERS SERVICE ENGINEERING DIVISION	
SURVEY MAP	
FOR	
JAMES YANNOY	
DRAWN BY: USA REYNOLDS	
SCALE 1"=100'	DATE 12/30/87
SHEET 1 OF 1	ENC. NO: 1908

RECORD # 30412  
LANGLADE COUNTY SURVEYORS OFFICE  
DATE FILED: 09/93 BY: DT.