

Lot 157
 Assessors Plat
 City of Antigo Wis
S.W. 1/4 S.E. 1/4 EXCEPT THE S. 200 FEET.
SECTION 20 T. 31 N. R. 11 E.
SCALE 1" = 100'

10-23-48 HENRY OLC ENG
 ANTIGO WIS
 RECORD # 30342 (EXTRA)
 LANGLADE COUNTY SURVEYORS OFFICE
 DATE FILED: _____ BY: _____

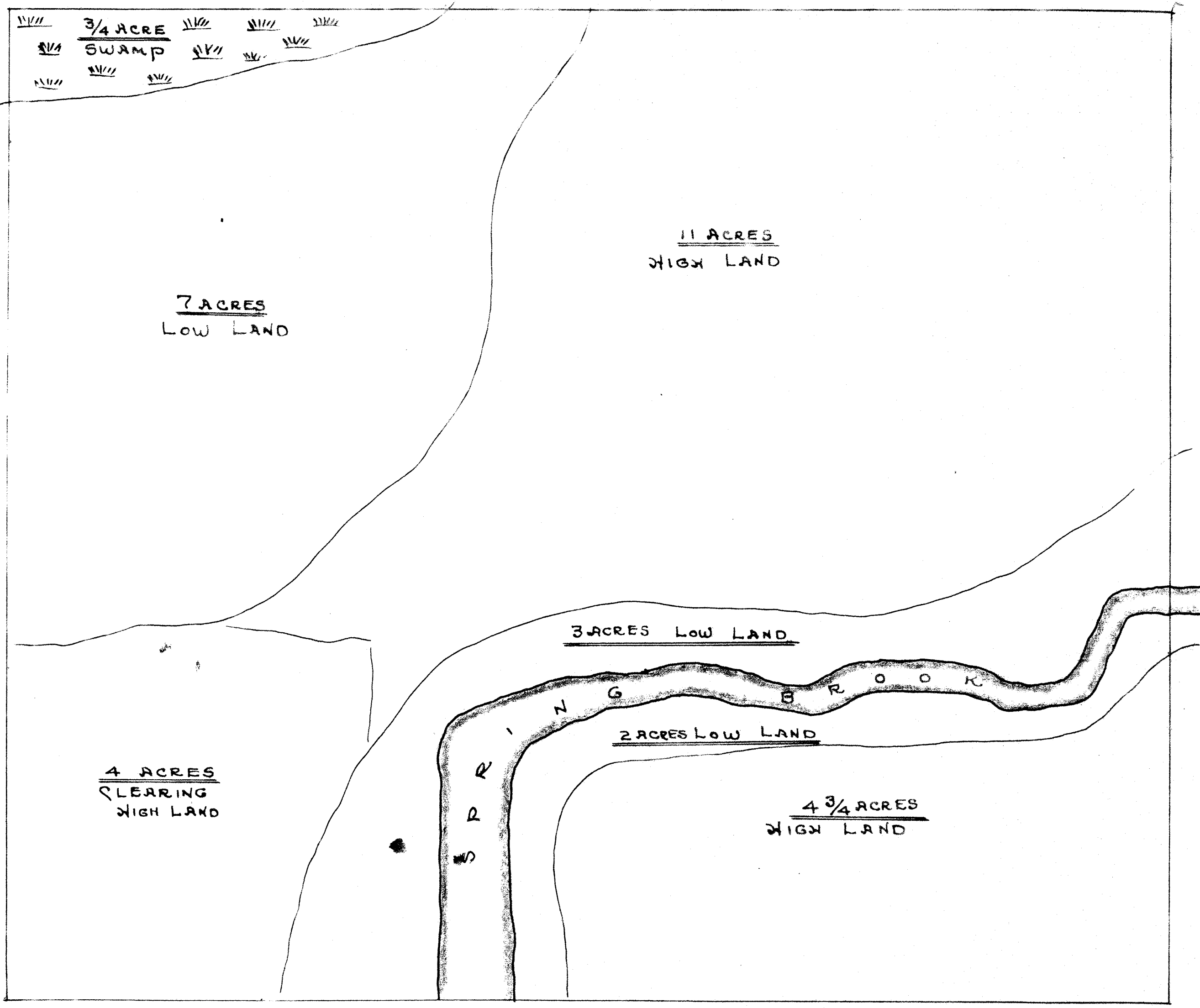

LOT 157
 ASSESSORS PLAT
 CITY OF ANTIGO WIS
S.W. 1/4 S.E. 1/4 EXCEPT THE S. 200 FEET.
SECTION 20 T. 31 N. R. 11 E.
SCALE 1" = 100'

10-23-98 HENRY OLK. ENG
 ANTIGO WIS

RECORD # 30342
 LANGLADE COUNTY SURVEYORS OFFICE
 DATE FILED: 6/8/93 BY: DT