

MAP OF SURVEY
FOR GERALD PREGLER

LOCATED IN THE S 1/2 NE 1/4 AND THE N 1/2 SE 1/4, SECT. 18,
T30N, R11E, TOWN OF ROLLING, LANGLADE CO, WISCONSIN

- LEGEND:
- o IRON PIPE, SET
 - x PK NAIL SET OVER IRON
 - BURIED IN ROAD

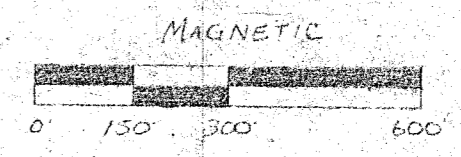

SCALE: 1" = 300'

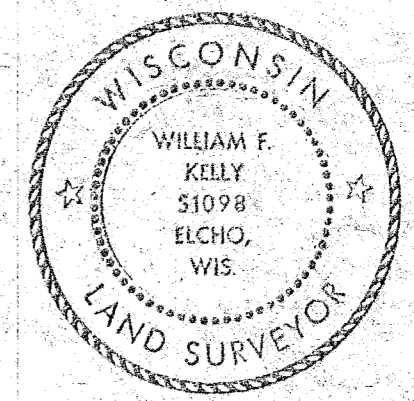

William F. Kelly
11-17-82

BUILDERS SERVICE ENGINEERING DIVISION	
GERALD PREGLER	
SECT. 18	
T30N, R11E	
DRAWN BY: LISA MEYER	CK. W.F. Kelly
SCALE 1" = 300'	DATE Nov. 16, 1982
SHEET 1 OF 1	DWG. NO: 1032

S 1/2 COR. ON 1/4 LINE, SECT. 18
LOCATED BY OCCUPATION
T30N, R11E

S 1/2 COR. 18/17
LOCATED BY OCCUPATION
T30N, R11E