

This area is purposely distorted to show the the "miss" at the existing section corner monument, resulting from the extension of straight lines connecting existing monuments.

History developed from available records for the Section corner common to Sections 1, 2, 11 & 12, Township 34 North, Range 12 East

1859 J.L. Nowlin, original government survey. Set corner post and two cedar bearing trees.

October 1926 W.C. Webley, County Surveyor, found the corner and "org. BT standing", as noted in County Surveyor record FB 94 on Page 176.

Sept. 1977, William Stuth, surveyor for Owens-Illinois, noted this corner as "By others" and shows it in his map legend as "iron pipe or cap". Said map filed as Map 10378 in the County Surveyor records and it shows distances to 16th corner and quarter corner to the east.

Sept. 1979 Certified Land Corner restoration form by William F. Kelly, indicates that he "located iron bar and old 4x4 cedar post. Post was lying next to iron bar. Located two existing B.T.". Kelly "set 2" x 42" IP with brass cap at cor. location. Set 4x4 cedar post next to pipe as a witness."

Nov. 1980, Va-Kay-Shun Land plat was recorded. It was surveyed by Wm. Kelly and shows this section corner as the 2" iron pipe set by Kelly in 1979. Lot corners west of this section corner were shown as being on the section line.

5/23/2024 I found the 2" iron pipe with brass cap and bearing trees mentioned by Kelly. There are cedar stumps in the area by none can be identified as original bearing tree stumps. Also found a 1-1/4 inch iron pipe lying on the ground next to the corner monument. After measuring to existing monuments to the east and existing lot corner monuments to the west, as shown on the Va-Kay-Shun Land plat, and having personal knowledge of the quality of work done by both Stuth and Kelly, I accept the location of the existing monument as the same position its been in since at least 1977 when Stuth mentioned it.

I, David E. Tlusty, Professional Land Surveyor, do hereby certify that by the direction of the Langlade County Forestry Department, Al Murray, Administrator, I have made a survey to confirm the location of the existing monument at the section corner common to Sections 1, 2, 11 & 12, Township 34 North, Range 12 East, Langlade County, Wisconsin. Said confirmation of the corner was required as there were several area owners who thought the corner monument may have been moved. Upon completion of the field work and after an examination of existing documentation mentioned in the history hereon, I believe that the corner monument as it exists is, in my opinion, in the same location as it has been since at least 1977. I further certify that this map is a true and correct representation of said survey and that this work is correct to the best of my knowledge and belief.

May 28, 2024

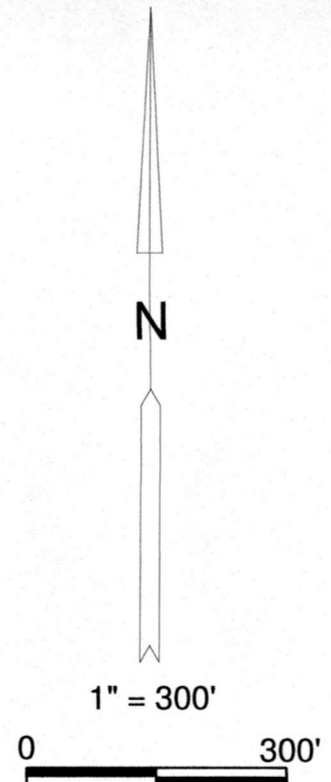
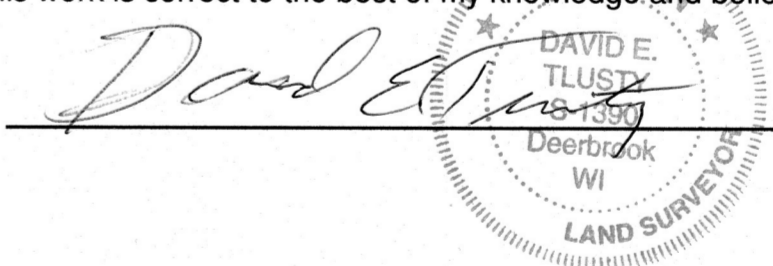

- LEGEND**
- 2" (id) iron pipe with brass cap found
 - 1-1/4" (id) iron pipe found unless noted otherwise
 - 1" (OD) x 24" iron pipe set
- Bearings and coordinates shown are referenced to the Langlade County coordinate system NAD83(2011) datum.
- Ownership information taken from the Langlade County Geographic Information System (GIS) website.

RECORD # 30130
LANGLADE COUNTY SURVEYORS OFFICE
DATE FILED: 5/30/24 D.T.

David E. Tlusty, PLS Deerbrook, Wisconsin 54424			
Survey for Langlade County Forestry Dept. The corner to Sections 1, 2, 11 & 12 T. 34 N., R. 12 E.			
SCALE: 1" = 300'	DATE: May 2024	DRAWN BY: dt	MAP #: