

WISCONSIN
 LANGLADE CO.
 TOWN OF ANTIGO
 T.31N., R.11E.
 N.W. COR. OF SEC. 11

NEFF SWITCH RD.

DESCRIPTION

A parcel of land located in the Northwest one-quarter (NW $\frac{1}{4}$) of the Northwest one-quarter (NW $\frac{1}{4}$) of Section 11, T.31N., R.11E., Town of Antigo, Langlade County, Wisconsin, being more particularly described as follows;

Commencing at the Northwest Corner (NW) of Section 11, T.31N., R.11E., Langlade County, Wisconsin, Thence S0°-00'-00"W along the West Section Line of said Section 11, 754.00 feet, Thence N89°-00'-00"E, 33.00 feet to the East Right of Way Line of County Trunk Highway "V" and the Point of Beginning, Thence N89°-00'-00"E, 267.00 feet, Thence S0°-00'-00"W, 216.00 feet, Thence S89°-00'-00"W, 267.00 feet to the East Right of Way Line of County Trunk Highway "V", Thence N0°-00'-00"E along the East Right of Way Line of County Trunk Highway "V", 216.00 feet to the Point of Beginning.

I, Gary A. Radtke, Registered Land Surveyor certify that I made such survey and map under the direction of Miles Homes Inc. owners of said land. That the map is a correct representation of all exterior boundaries of the survey.

Dated 23Nov76

Gary A. Radtke S-1248

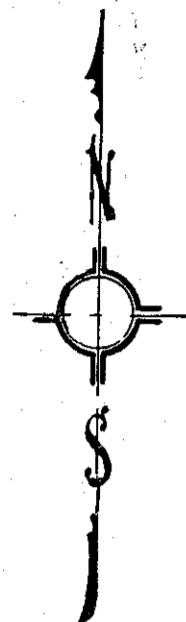

C.T.H. "V" 754.00'

N89°00'00"E 200.00'
 N0°00'00"E 216.00'
 33'
 66'

N.89°-00'-00"E
 267.00'

DUFF

N.89°-00'-00"E
 267.00'

MC CORKLE

S.89°-00'-00"W
 267.00'

200.00'
 S.00°-00'-00"W

216.00'

SCALE: 1" = 100'

C.T.H. "V"

66'

143'

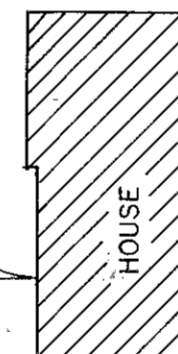

HOUSE

MC CORKLE

72'

● 1" IRON PIPE

SCALE: 1" = 30'

RECORD # 30098

LANGLADE COUNTY SURVEYORS OFFICE

DATE FILED: 5/24/93 BY: D.T.

DYNAMIC ENGINEERING - SURVEYING

SCALE	REVISIONS	BY	DATE
DATE 11-22-76			
DR. J.F.	CKD.		
AP. VD.			
TITLE	MILES HOMES		NO. 538