

CURVE TABLE					
CURVE	ARC LENGTH	RADIUS LENGTH	CENTRAL ANGLE	CHORD BEARING	CHORD LENGTH
C1	36.52'	565.24'	3°42'06"	N04°33'21"W	36.51'

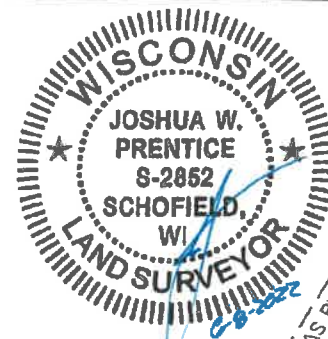

# PLAT OF SURVEY

ALL OF LOT 10, EXCEPT THE NORTH 18 FEET THEREOF, AND ALL OF LOT 11 OF ISLE OF PINES PLAT, LOCATED IN GOVERNMENT LOT 5 OF SECTION 22, TOWNSHIP 34 NORTH, RANGE 11 EAST, TOWN OF ELCHO, LANGLADE COUNTY, WISCONSIN.

**SURVEYOR'S CERTIFICATE**  
 I JOSHUA W. PRENTICE, WISCONSIN PROFESSIONAL LAND SURVEYOR S-2852, DO HEREBY CERTIFY TO THE BEST OF MY KNOWLEDGE AND BELIEF: THAT I HAVE SURVEYED AND MAPPED ALL OF LOT 10, EXCEPT THE NORTH 18 FEET THEREOF, AND ALL OF LOT 11 OF ISLE OF PINES PLAT, LOCATED IN GOVERNMENT LOT 5 OF SECTION 22, TOWNSHIP 34 NORTH, RANGE 11 EAST, TOWN OF ELCHO, LANGLADE COUNTY, WISCONSIN.

THAT SAID PARCEL CONTAINS ±24,066 SQUARE FEET, ±0.552 ACRES, MORE OR LESS.

THAT I HAVE MADE THIS SURVEY AND MAP THEREOF AT THE DIRECTION OF MATT HAHM, OWNER OF SAID PARCEL.

THAT SAID PARCEL IS SUBJECT TO EASEMENTS, RESTRICTIONS, AND RIGHTS-OF-WAY OF RECORD.

THAT I HAVE FULLY COMPLIED WITH THE PROVISIONS OF WISCONSIN ADMINISTRATIVE CODE A-E7.

THAT SAID PARCEL IS A CORRECT AND ACCURATE REPRESENTATION OF THE EXTERIOR BOUNDARY OF SAID PARCEL.

DATED THIS 8<sup>th</sup> DAY OF JUNE 2022

REI  
 JOSHUA W. PRENTICE  
 WI P.L.S. S-2852

- NOTES:**
- BEARINGS ARE BASED ON THE LANGLADE COUNTY COORDINATE SYSTEM, NAD 83(2011) DATUM AND REFERENCED TO THE SOUTH LINE OF THE SOUTHEAST 1/4 OF SECTION 22, TOWNSHIP 34 NORTH, RANGE 11 EAST, MEASURED TO BEAR NORTH 88°49'21" EAST.
  - FIELD WORK WAS COMPLETED ON 5-27-2022.
  - APPROXIMATE LOCATION OF THE ORIGINAL PLAT LINES SHOWN BY GREY DASHED LINES BASED UPON DIMENSIONS SHOWN ON THE ORIGINAL PLAT.
  - BASED UPON THE ORIGINAL ISLE OF PINES PLAT DIMENSIONS THIS REFLECTS THE APPROXIMATE PLATTED ROAD LOCATION. IT APPEARS THAT IN THIS AREA (LOTS 13-7) THE TOWN ROAD HAS BEEN CONSTRUCTED CONSIDERABLY TOO FAR TO THE WEST, AND ALL OF THE LOTS INVOLVED HAVE OCCUPIED TO THE EXISTING TOWN ROAD.
  - BENCHMARK #2 IS A 6 INCH SPIKE SET IN UTILITY POLE 3411-22E46, LOCATED SOUTH 27°28'25" EAST, 97.61 FEET FROM THE SOUTHWEST CORNER OF LOT 11 OF ISLE OF PINES PLAT, ELEVATION 1526.00'.

LEGEND	
	- CONIFEROUS TREE
	- DECIDUOUS TREE
	- STUMP
	- UTILITY PEDESTAL
	- DOWNSPOUT
	- ELECTRIC METER
	- ELECTRIC TRANSFORMER
	- SEPTIC TANK
	- SEPTIC VENT
	- TELECOMMUNICATION LINE
	- UNDERGROUND GAS
	- UNDERGROUND ELECTRIC
	- TREE LINE
	- 1 IN. BAR FOUND UNLESS NOTED
	- 1 IN. O.D. IRON PIPE FOUND
	- 1-1/4 IN. O.D. IRON PIPE FOUND
	- 1-1/2 IN. O.D. IRON PIPE FOUND
	- STEEL T-POST FOUND
	- 1-1/4 IN. O.D. X 18 IN. IRON PIPE WEIGHING 1.68 LBS/LIN. FT. SET
	- BENCHMARK
	(126') - RECORDED BEARING/LENGTH
	126.00' - MEASURED BEARING/LENGTH
	- RETAINING WALL
	- CONCRETE
	- LANDSCAPING
	- PROPERTY LINE

DRAWING FILE: Q:\10428\10428 - MATT HAHM - N0791 W. ISLE OF PINES DRIVE - POST LAKE\DRAWING\10428 PLAT OF SURVEY.DWG LAYOUT: PLAT OF SURVEY-11X17  
 PLOTTED: JUN 08, 2022 - 11:54AM PLOTTED BY: MELS

**REI Engineering, Inc.**  
 4880 N. 20TH AVENUE  
 WAUSAU, WISCONSIN 54401  
 PHONE: 715.675.9784 FAX: 715.675.4060  
 EMAIL: MAIL@REIENGINEERING.COM

**REI CIVIL & ENVIRONMENTAL ENGINEERING, SURVEYING**



DATE	REVISION	BY	CHK'D	DESIGNED BY:	CHECKED BY:
					JWP
				SURVEYED BY: AJB, BDE	APPROVED BY: JWP
				DRAWN BY: MJS	DATE: 6-1-2022

**PLAT OF SURVEY**  
 HAHM RESIDENCE  
 N10791 WEST ISLE OF PINES DRIVE  
 ELCHO, WISCONSIN

REI No. 10428  
 SHEET 1 OF 1

RECORD # 20535  
 LANGLADE COUNTY SURVEYORS OFFICE  
 DATE FILED: 7/13/22 BY: D. TEUSTY