

PLAT OF SURVEY

LOT 9 OF THE LE FREEMAN PLAT, LOCATED IN
GOVERNMENT LOT 1, SECTION 17, T32N-R14E, TOWN
OF WOLF RIVER, LANGLADE COUNTY, WISCONSIN

BEARINGS REFERENCED TO THE LANGLADE
COUNTY COORDINATE SYSTEM GRID.

LEGEND

- △ COMPUTED POINT
- ⊙ FOUND IRON PIPE (SIZE NOTED)
- SET 1.05" O.D. X 18" LONG IRON PIPE WEIGHING 1.13 LBS/LF

SCALE 1 INCH = 35 FEET



I, TIMOTHY J. RUSCH, PROFESSIONAL LAND SURVEYOR, DO
HEREBY CERTIFY:

THAT I HAVE SURVEYED AND MAPPED BY THE ORDER OF PAUL
TUROWSKI, OWNER, LOT 9 OF THE L.E. FREEMAN PLAT, LOCATED
IN GOVERNMENT LOT 1 OF SECTION 17, T32N-R14E.

DESCRIBED AS FOLLOWS:

COMMENCING AT THE SOUTHEAST CORNER OF SECTION 17;
THENCE N00°06'46"W, ALONG THE EAST LINE OF THE SE 1/4 OF
SAID SECTION, 844.34 FEET; THENCE S89°53'14"W, 598.89 FEET TO
THE POINT OF BEGINNING; THENCE S12°52'06"E, 222.01 FEET TO A
MEANDER CORNER WHICH LIES N12°52'06"W, 11 FEET MORE OR
LESS FROM THE APPROXIMATE ORDINARY HIGH WATER MARK OF
SAWYER LAKE; THENCE S82°51'10"W, ALONG A MEANDER LINE,
74.95 FEET TO A MEANDER CORNER WHICH LIES N11°10'24"W, 13
FEET MORE OR LESS FROM THE APPROXIMATE ORDINARY HIGH
WATER MARK OF SAID LAKE; THENCE N11°10'24"W, 210.22 FEET;
THENCE N73°26'03"E, ALONG THE SOUTH RIGHT-OF-WAY OF EAST
HOLLISTER ROAD, 68.50 FEET TO THE POINT OF BEGINNING.

THAT THIS SURVEY WAS FOR THE PURPOSE OF LOCATING
PROPERTY BOUNDARIES ONLY. OTHER GEOGRAPHICAL
FEATURES WERE NOT MAPPED.

THAT THIS IS A TRUE AND CORRECT REPRESENTATION OF THE
BOUNDARIES SURVEYED TO THE BEST OF MY KNOWLEDGE AND
BELIEF.

SURVEYED BY:
RUSCH ENGINEERING &
SURVEYING LLC
400 RUSCH ROAD
ANTIGO, WI 54409
(715)623-5044
PROJECT #18-5950

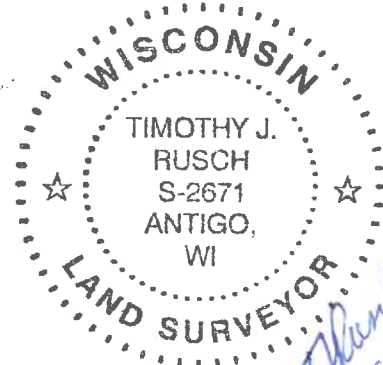

*Thank
05-23-2019*

L.E. FREEMAN PLAT

BIRCH POINT
ROAD

EAST HOLLISTER ROAD
CENTERLINE AS TRAVELLED
50' WIDE RIGHT-OF-WAY

APPROXIMATE LOCATION OF PLATTED ROADWAY

DEED #282357
TOTAL AREA
0.38 ACRES
(16,442 SQ. FT.)

D. GURINIAN
DEED #442349

J. STOELTING
C. MCGREGOR
DEED #434836

D. STOELTING
DEED #262579

SEPTIC
VENTS

SEPTIC
TANK

WELL

CABIN

PROPANE
TANK

BOAT
HOUSE

EAST 1/4
CORNER
SECTION 17
FOUND
IRON PIPE

SE CORNER
SECTION 17
FOUND
BRASS
CAPPED
MONUMENT

RECORD # 20500
LANGLADE COUNTY SURVEYORS OFFICE
DATE FILED: 11/29/2020 BY: P. TRUSTY

SAWYER LAKE

LOT 12

LOT II

LOT II

LOT 10

LOT 10

LOT 9

LOT 8

LOT 7

LOT 8

LOT 9

LOT 8

LOT 7