

RECORD # 11184
 LANGLADE COUNTY SURVEYORS OFFICE
 DATE FILED: 2/19/25 BY: D.T.

PLAT OF SURVEY

PART OF LOT 8 BLOCK 1 VILLAGE OF SUMMIT LAKE PLAT
 LOCATED IN NW 1/4 NW 1/4 OF SECTION 1,
 T33N-R10E, TOWN OF UPHAM,
 LANGLADE COUNTY, WISCONSIN

I, Timothy J. Rusch, Professional Land Surveyor, hereby certify:

That I have surveyed and mapped by the order of Dayna Streeting, a parcel described in Deed #464372, being part of Lot 8 Block 1 of the Village of Summit Lake Plat, Located in Section 1, T33N-R10E, Town of Upham, Langlade County, Wisconsin. Said parcel is more particularly described as follows:

Commencing at the West 1/4 Corner of said Section 1, Thence N04°48'16"E, along the West line of the NW 1/4 of said Section, 1292.66 feet; Thence N45°00'00"E, 177.93 feet to the Point of Beginning, an iron pipe located N83°55'28"E, 25 feet more or less from the water's edge of Summit Lake; Thence N83°55'28"E, 242.68 feet to an iron pipe; Thence N06°45'07"W, along the West right-of-way of Merlin Lane, 43.44 feet to an iron pipe; Thence S83°39'29"W, 237.91 feet to an iron pipe Meander Corner which lies N83°39'29"E, 29 feet more or less from the water's edge of Summit Lake; Thence S00°19'51"E, along a meander line, 42.54 feet to the Point of Beginning; including the lands between the meander line and the water's edge of Summit Lake, between the lot lines extended as shown on the map herewith.

That said parcel is subject to right-of-ways, easements, reservations, or restrictions in use or of record, including a 20' wide access easement as shown hereon.

That, to the best of my knowledge and belief this plat is a true and correct representation of the parcel described, and that I have complied with Wisconsin Statutes and the Land Division Regulations of Langlade County.

Dated this 10 day of October, 2024

T. Rusch
 Timothy J. Rusch
 Professional Land Surveyor # S-2671

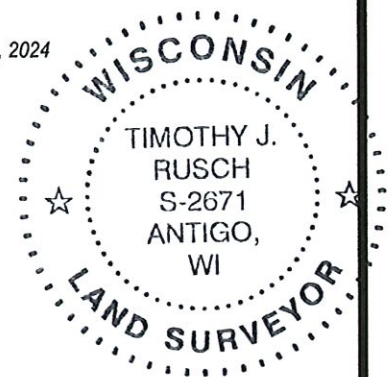

LEGEND

- IRON PIPE SET, 1.06" OD X 18" LONG, WEIGHING 1.13 LBS/LF
- 2" IRON PIPE FOUND
- ⊙ 1" IRON PIPE FOUND
- △ CALCULATED POSITION

SURVEYED BY:
 RUSCH ENGINEERING &
 SURVEYING LLC
 400 RUSCH ROAD
 ANTIGO, WI 54409
 (715)216-0385
 PROJECT #24-6358

