

PLAT OF SURVEY

LOT 1 OF BLOCK 1 OF SUNSET VIEW PARK PLAT, LOCATED IN GOVERNMENT LOT 8 OF SECTION 11, AND GOVERNMENT LOT 3 OF SECTION 2, T34N-R11E, TOWN OF ELCHO, LANGLADE COUNTY, WISCONSIN

RECORD # 11123
 LANGLADE COUNTY SURVEYORS OFFICE
 DATE FILED: 9/28/22 BY: D.J.

SCALE: 1 INCH = 30 FEET



BEARINGS REFERENCED TO THE LANGLADE COUNTY COORDINATE SYSTEM GRID.

Parcel description:
 Commencing at the Northeast Corner of Section 11; Thence N87°09'10"W, along the North line of Government Lot 8 of said Section, 961.01 feet to the Point of Beginning; Thence S88°14'23"E, 223.88 feet; Thence S04°21'08"E, along the West right-of-way of Post Lake Drive, 49.97 feet; Thence N88°03'15"W, 200.17 feet to a meander corner which lies S88°03'15"E, 17 feet more or less from the approximate ordinary high water mark of Upper Post Lake; Thence N28°52'19"W, along a meander line, 56.99 feet to a Meander Corner which lies S88°14'23"E, 3 feet more or less from said approximate ordinary high water mark of said lake being the Point of Beginning.

I, Michael J. Hoffman, Professional Land Surveyor, Wisconsin Registration No. S-3032, do hereby certify that I have surveyed and mapped by the order of June Winkel, the lands shown hereon, and that said survey is true and correct to the best of my knowledge and belief, and that I have complied with the applicable requirements of Section AE-7 of the Wisconsin Administrative Code.

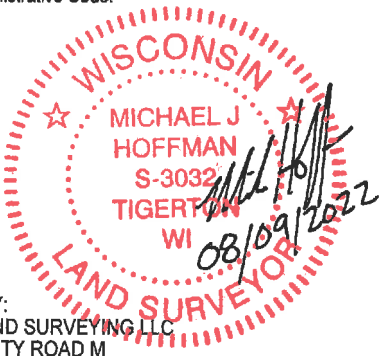

SURVEYED BY:
 HOFFMAN LAND SURVEYING LLC
 W14215 COUNTY ROAD M
 TIGERTON, WI 54486
 (715)853-4634
 PROJECT # 22-6621
 FIELDWORK COMPLETED: 08/08/2022

