

SURVEYOR ANTONIO W. KORDICK

LAND EXAMINATIONS

19

*Surveyed for*

EXAMINER

*Gene Larsen*

COUNTY

SEC

*May 21 - 1959*

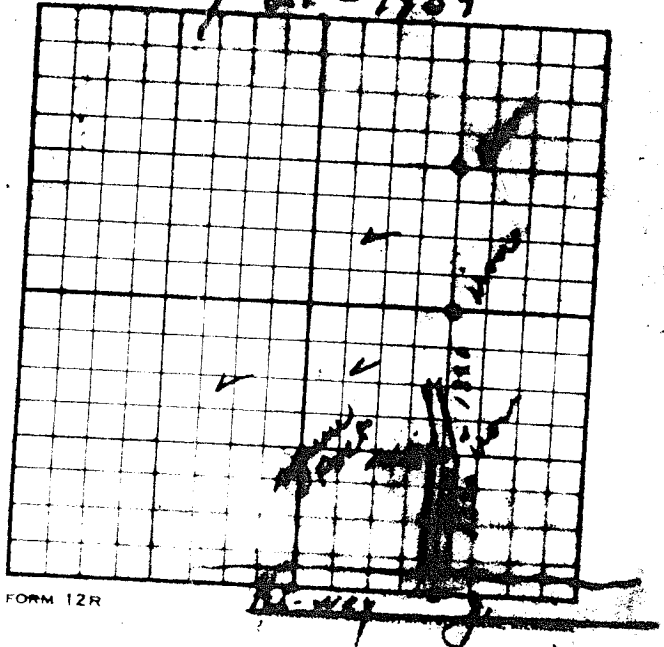

FORM 12R

Langlade Cty  
A.W. Kordick  
1963-1965

*Langlade County  
on Hi-way J.*

*Sec 35 T33N R9*

RECORD # *10558*

LANGLADE COUNTY SURVEYORS OFFICE

DATE FILED: *5/21/01* BY: *D. TUSTY*