

4351236 0020 2017

U.S. PUBLIC LAND SURVEY MONUMENT RECORD

Note: This form is intended and designed to fulfill all requirements of Wisconsin Administrative Code, Chapter A-E 7.08 U.S. Public Land Survey Monument Record (3)(a-l).

WISCRS - Langlade County

N: 458,751.48 USft

E: 676,698.38 USft

WISCRS - Forest County

N: 532,285.77 USft

E: 828,058.32 USft

Datum: NAD 83(2011)

GNSS Method: WISCORS RTN

	SEC. 1		
	T34N R12E		

(b) HISTORY OF ORIGINAL CORNER ESTABLISHMENT

Original Surveyor: Alfred Millard

Original Accessories:

Cedar 12" N39°E, 10 lks.
Tamarack 12" S52°W, 5 lks.

Date of Survey Commenced: August, 1857
Completed: August, 1857

(b)(f)(g)(h) Description of monument found at this corner and if it was accepted, state all evidence (material, testimonial, occupational, plats, records, other monuments) used as a basis for accepting. If not accepted or if nothing was found, state evidence used as basis for establishing location. If re-established through lost corner proportionate methods, indicate all monuments, distances and directions used to establish. Indicate type of monument and sign post found or set.

This is a perpetuation of a previous USPLS Monument Record by Stuart L. Foltz, RLS dated June 30, 1977 and filed in the office of the Forest County Register of Deeds. A complete history of the corner can be found on the previous monument record. I accept the previous location as a true and faithful perpetuation or reestablishment of the original corner location and further perpetuate it as follows.

To augment the record:

April 27, 1978: Survey of Sec. 36 for Exxon by Stuart L. Foltz, RLS indicates corner is marked by a Forest County aluminum monument with the following BT's: 8" cedar N85°W, 43.2', 7" cedar N22°E, 44.4', 6" cedar S86°W, 11.9'.

February 10, 2004: Survey in Sec. 36 by Michael A. Trembl, RLS indicates corner is marked by a Forest County aluminum monument.

October 21, 2016: I found and accepted the record monument, a 2-1/2" diam. aluminum pipe with a 3-1/4" diam. Forest Co. aluminum cap just beneath the bog/water surface. I set a DEEP-1 magnet adjacent to the monument. The stump of the GLO cedar bearing tree was found at record bearing and distance. The record bearing tree at S86°W is gone. I found or established accessories as shown below. I set a white vinyl sign post bearing North, 0.5 ft.

(c)(d)(e) Plan view of corner with ties to at least 4 witness monuments. If in disagreement with previously established corner, show the distances between the two corners and also indicate the ties to the disputed.

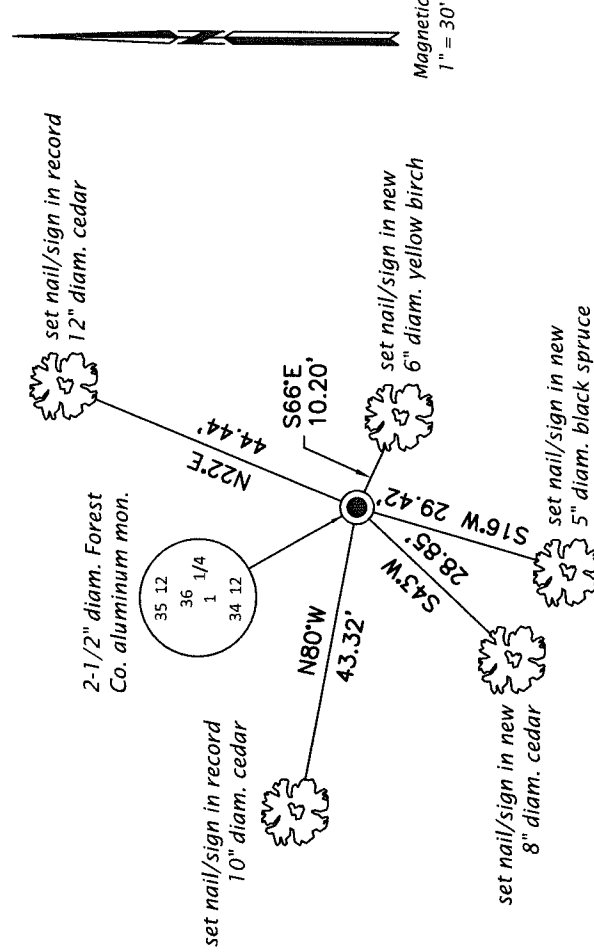

(i) I, Jeffrey W. Austin, Professional Land Surveyor No. S-1885, hereby certify that the corner location on this record was determined by me or under my direction and control and that this U.S. Public Land Survey Monument Record is correct and complete to the best of my knowledge and belief.

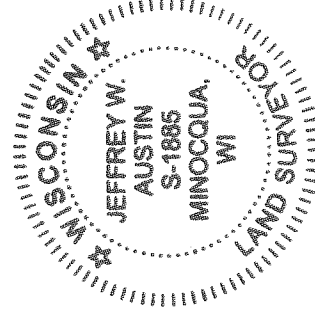

[Handwritten Signature]
Signature

MAY 4, 2017
Date