

4351234 0020 2017

**U.S. PUBLIC LAND SURVEY MONUMENT RECORD**

Note: This form is intended and designed to fulfill all requirements of Wisconsin Administrative Code, Chapter A-E 7.08 U.S. Public Land Survey Monument Record (3)(a-l).

WISCRS - Langlade County

(a) CORNER LOCATION  
 1/4 Cor. of Secs. 3 & 34  
 Township 34 & 35 North  
 Range 12 East of the 4th P.M.  
 Town of Ainsworth/Nashville  
 County of Langlade/Forest

N: 458,656.92 USft  
 E: 666,173.82 USft  
 WISCRS - Forest County  
 N: 532,243.53 USft  
 E: 817,533.45 USft  
 Datum: NAD 83(2011)  
 GNSS Method: WISCRS RTN

		SEC. 3	
		T34N R12E	

(b) HISTORY OF ORIGINAL CORNER ESTABLISHMENT

Original Surveyor: Alfred Millard

Original Accessories:

Date of Survey      Commenced: August, 1857  
 Completed: August, 1857

Y. Pine 18" N54°E, 85 lks.  
 B. Oak 10" S27°E, 48 lks.

(b)(f)(g)(h) Description of monument found at this corner and if it was accepted, state all evidence (material, testimonial, occupational, plats, records, other monuments) used as a basis for accepting. If not accepted or if nothing was found, state evidence used as basis for establishing location. If re-established through lost corner proportionate methods, indicate all monuments, distances and directions used to establish. Indicate type of monument and sign post found or set.

*This is a perpetuation of a previous USPLS Monument Record by Thomas R. Arnott, RLS dated November 11, 1975 and filed in the office of the Forest County Register of Deeds. A complete history of the corner can be found on the previous monument record. I accept the previous location as a true and faithful perpetuation or reestablishment of the original corner location and further perpetuate it as follows.*

*This is a perpetuation of a previous USPLS Monument Record by William F. Kelly, RLS dated November 9, 1990 and filed in the office of the Langlade County Surveyor. A complete history of the corner can be found on the previous monument record. I accept the previous location as a true and faithful perpetuation or reestablishment of the original corner location and further perpetuate it as follows.*

*October 22, 2016: I found and accepted the record monument, a 2-1/2" diam. aluminum pipe with a 3-1/4" diam. Forest Co. aluminum cap projecting 8" above a ring of stone. I set a DEEP-1 magnet adjacent to the monument. The record bearing tree at N24°E is dead and the tree at S22°W is gone. I found or established accessories as shown below. I found a white vinyl sign post bearing East, 0.8 ft.*

(c)(d)(e) Plan view of corner with ties to at least 4 witness monuments. If in disagreement with previously established corner, show the distances between the two corners and also indicate the ties to the disputed.

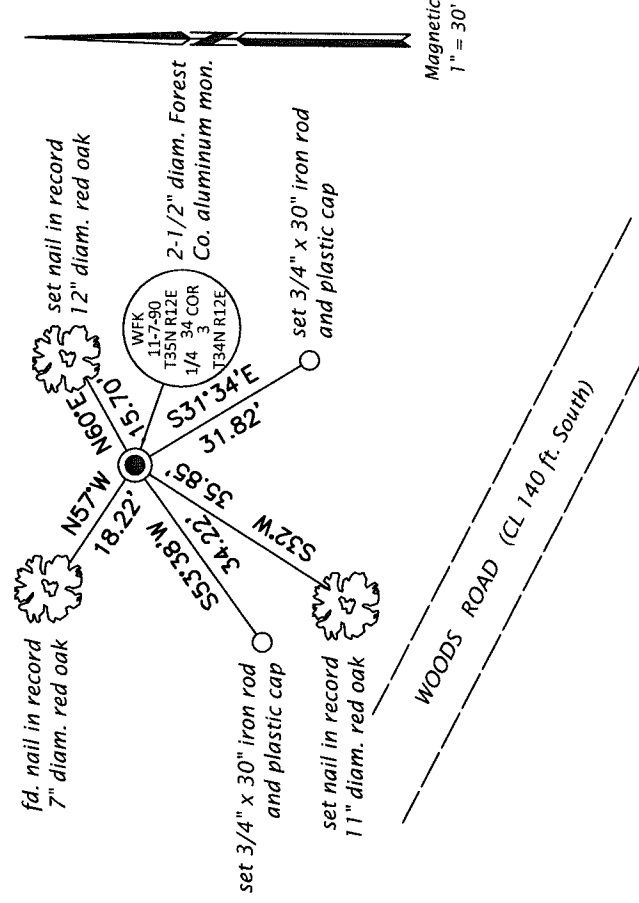

(i) I, Jeffrey W. Austin, Professional Land Surveyor No. S-1885, hereby certify that the corner location on this record was determined by me or under my direction and control and that this U.S. Public Land Survey Monument Record is correct and complete to the best of my knowledge and belief.

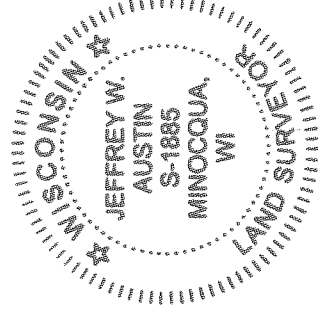

*[Handwritten Signature]*  
 Signature

May 4, 2017  
 Date