

4351233 0000 2017

U.S. PUBLIC LAND SURVEY MONUMENT RECORD

Note: This form is intended and designed to fulfill all requirements of Wisconsin Administrative Code, Chapter A-E 7.08 U.S. Public Land Survey Monument Record (S)(a-h).

WISCONSIN - Langlade County

N: 458,716.08 USft
E: 663,556.49 USft

WISCONSIN - Forest County

N: 532,315.71 USft
E: 814,916.45 USft

Datum: NAD 83(2011)

GNSS Method: WISCONSIN RTN

		SEC. 4	
		T34N R12E	

(b) HISTORY OF ORIGINAL CORNER ESTABLISHMENT

Original Surveyor: Alfred Millard

Original Accessories:

Date of Survey Commenced: August, 1857
Completed: August, 1857

Y. Pine 14" N5°E, 85 lks.
Y. Pine 15" N40°W, 48 lks.
W. Pine 18" S20°W, 58 lks.
Y. Pine 15" S55°E, 40 lks.

(b)(f)(g)(h) Description of monument found at this corner and if it was accepted, state all evidence (material, testimonial, occupational, plats, records, other monuments) used as a basis for accepting. If not accepted or if nothing was found, state evidence used as basis for establishing location. If re-established through lost corner proportionate methods, indicate all monuments, distances and directions used to establish. Indicate type of monument and sign post found or set.

This is a perpetuation of a previous USPLS Monument Record by Raymond J. Hallisy, RLS dated July 27, 1968 and filed in the office of the Langlade County Surveyor. A complete history of the corner can be found on the previous monument record. I accept the previous location as a true and faithful perpetuation or reestablishment of the original corner location and further perpetuate it as follows.

This is a perpetuation of a previous USPLS Monument Record by Thomas R. Arnott, RLS dated November 11, 1975 and filed in the office of the Forest County Register of Deeds. A complete history of the corner can be found on the previous monument record. I accept the previous location as a true and faithful perpetuation or reestablishment of the original corner location and further perpetuate it as follows.

To augment the record:

1932-1934: Survey notes by Charles W. Borth, Langlade County Surveyor Record #10317. "Flat stone with "+" on top. Could not find any original B.T's. Unrecorded BT Norway stump N15°W, 40 ft. Set 3" iron pipe on W. side of stone."

October 22, 2016: I found and accepted a monument of unknown origin, a 2-1/2" diam. aluminum pipe with a 3-1/4" diam. Forest Co. aluminum cap projecting 6" above the ground surface. I set a DEEP-1 magnet adjacent to the monument. As described in the record, a 4" diam. brass-capped iron pipe bears West, 1.3 ft. The record birch and red pine at S14°W are both gone. I found or established accessories as shown below. I set a white vinyl sign post bearing North, 0.7 ft.

(c)(d)(e) Plan view of corner with ties to at least 4 witness monuments. If in disagreement with previously established corner, show the distances between the two corners and also indicate the ties to the disputed.

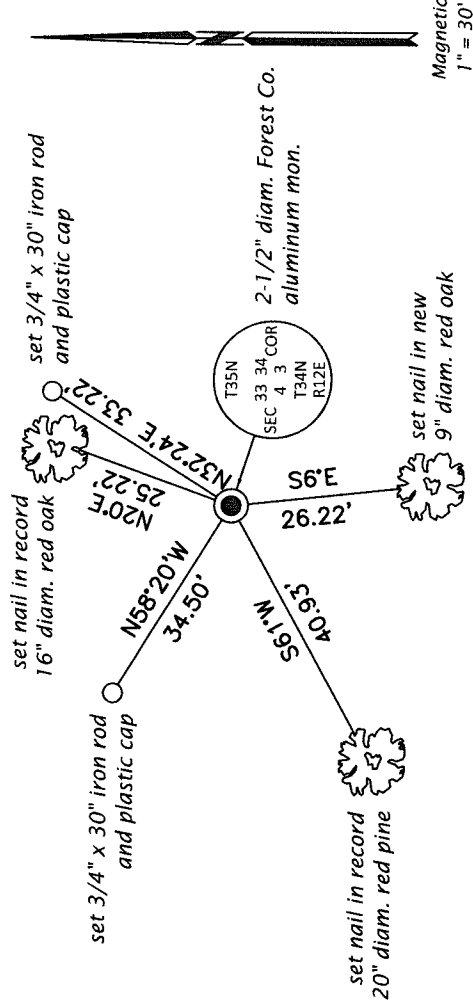

WOODS ROAD (CL 55 ft. South)

(i) I, Jeffrey W. Austin, Professional Land Surveyor No. S-1885, hereby certify that the corner location on this record was determined by me or under my direction and control and that this U.S. Public Land Survey Monument Record is correct and complete to the best of my knowledge and belief.

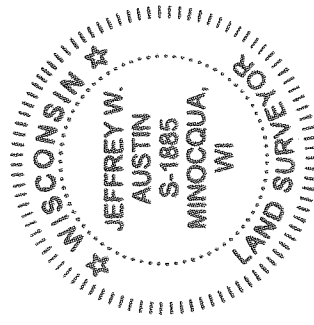

[Signature]
Signature

MAY 4 2017
Date