

CERTIFIED LAND CORNER RESTORATION

34-10

Index No. **A-13**

State of Wisconsin }
County of Langlade } ss.

I Raymond J. Hallisy, do hereby certify that on the 27th day of July, 1968, I found evidence of the Section corner of 33, 34, 4, & 3 Township 34 & 35, North, Range 12, Fourth Principal Meridian, as described hereon; and that from this evidence I established a new monument and accessories as described hereon to perpetuate the original location of this corner.

Resident witnesses:

.....
.....
.....

History of original corner establishment:

Corner set in the 1930's by: C. W. Borth

Description of corner evidence found:

Found flat rock marked + with a 4" iron pipe 1.3Ft. west

Description of monument and accessories I established to perpetuate the original location of this corner.

Set Brass Cap in the 4" pipe and filled pipe with cement

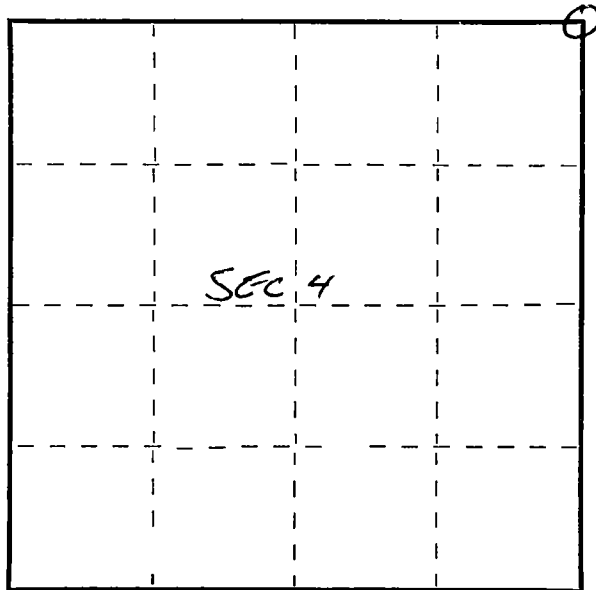

○ = Corner monument restored.

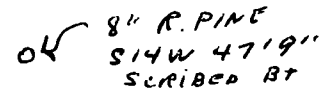
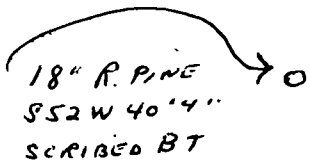
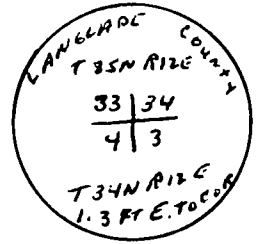
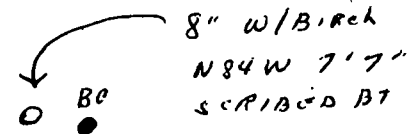

Dated at Antigo, Wis., this 27th day of July, 1968

Signature Raymond J. Hallisy Title Reg. Land Surveyor Registration No. 2-685
(County Surveyor, Registered Land Surveyor or other duly authorized official)

Office of Register of Deeds, County of _____, I hereby certify that the within instrument was filed in this office for record on the _____ day of _____, 19____ at _____ o'clock _____ M.

(Register of Deeds)

By _____ Deputy

4351233 0000

FORM 985 H. C. MILLER CO., MILWAUKEE