

CERTIFIED LAND CORNER RESTORATION

34-11

Index No. A-15-16

State of Wisconsin }  
County of LANGLADE } ss.

I ROBERT J. POSS, do hereby certify that on the 1ST day of JULY, 1967, I found evidence of the Meander Cor. corner of SEC'S 3 & 34 Township 34 & 35 R2P; North, Range 11 EAST, Fourth, Principal Meridian, as described hereon; and that from this evidence I established a new monument and accessories as described hereon to perpetuate the original location of this corner.

History of original corner establishment:

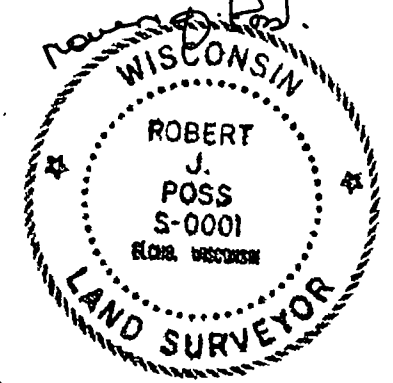

Description of corner evidence found:  
2" IRON PIPE; 5Q'D STAKE 15" BELOW GROUND.

Resident witnesses:

Description of monument and accessories I established to perpetuate the original location of this corner.

SET 1 1/2" IRON PIPE WITH 4" BRASS CAP IN 6"D x 42" CONCRETE.  
CAP MARKED ONEIDA COUNTY - T35N R11E  
MEA. SEC. 34 COR.  
LANGLADE COUNTY T34 N. R11E

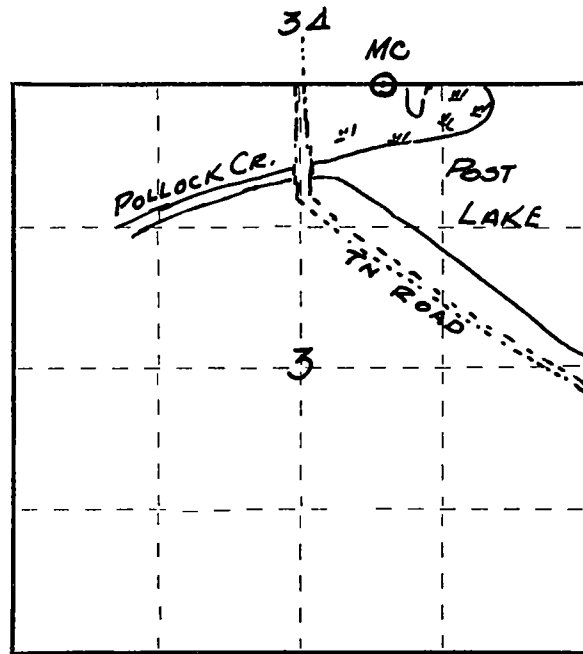

- TREES BLAZED - NO SCRIBE.
- X1 = SE COR. MET. GAR. N4°E 57.2'
- X2 = SW COR. MET. GAR N8°W 64.0'
- X3 HD. MAPLE 12" N2°W 35.7' SW. SIDE
- X4 W. SPRUCE 12" N68°W 50.7'
- X4 HD. MAPLE 14" S58°W 14.7'

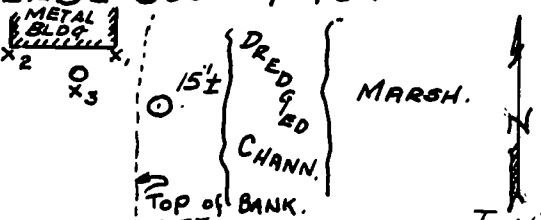

Dated at ELCHO, Wis., this 1ST day of JULY, 1967

Signature: Robert J. Poss Title: REG. LAND SURVEYOR Registration No. S-0001  
(County Surveyor, Registered Land Surveyor, or other duly authorized official)

Office of Register of Deeds, County of \_\_\_\_\_, I hereby certify that the within instrument was filed in this office for record on the \_\_\_\_\_ day of \_\_\_\_\_, 19\_\_\_\_ at \_\_\_\_\_ o'clock \_\_\_\_\_ M.

(Register of Deeds)

By \_\_\_\_\_ Deputy

○ = Corner monument restored.

FORM 985 H. C. MILLER CO., MILWAUKEE