

CERTIFIED LAND CORNER RESTORATION

Index No. A-11

State of Wisconsin }  
County of Langlade } ss.

I, Philip T. Hansen, do hereby certify that on the 27th day of April, 1976, I found evidence of the Quarter corner of Section 33-4 Township 34, North, Range 11 East, Fourth Principal Meridian, as described hereon; and that from this evidence I established a new monument and accessories as described hereon to perpetuate the original location of this corner.

Resident witnesses

Glen Barker

Jim Claflin

Herb Wagoner

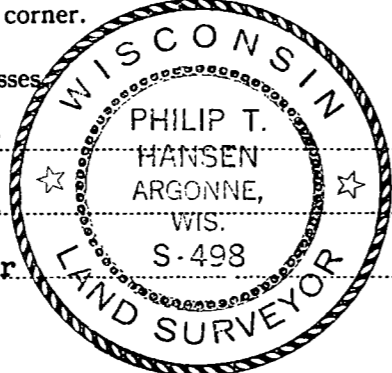

FORM 985

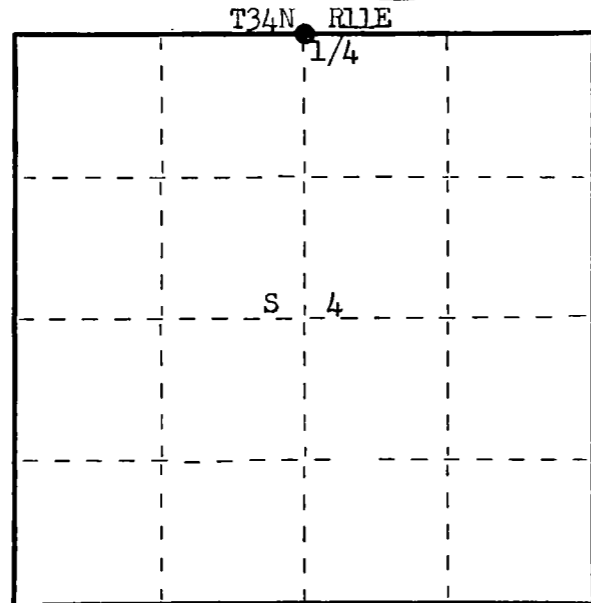

○ = Corner monument restored.

History of original corner establishment: Original corner established by Hiram C. Fellows, Deputy Surveyor in 1859, from which Maple 14" bears N32°E 20 lks, and Maple 9" bears N70°W 20 lks.

Corner recovered by H. C. Lawrence, Registered Land Surveyor, in 1948. Recovered 4" Hemlock Post, at 41.69 chs east of Section Corner common to Sec. 32-33, 5 and 4. Recovered Hemlock 16" S53°E 14 lks and Y. Birch 18" N64°W, 7 lks. Set a 5" cedar post squared and scribed for corner. Marked NBTs - Sugar 20" S71°W 23 lks. and Sugar 6" N5°W 34 lks. A boulder outcrop 3 ft. x 4 ft. bears N 10° W 30 lks.

Description of corner evidence found:

Recovered 5" squared cedar post, scribed 1/4 S, S4, 1/4 S S33 in fair condition. Also an old squared post, 2 ft. high beside it, scribed 1/4 S. Found a rock cairn built around base. Recovered OBT Sugar 20" S71°W 23 lks, scribed 1/4 S NBT, Sugar 6" (8") N5°W 34 lks, scribed 1/4 S.

Description of monument and accessories I established to perpetuate the original location of this corner.

Replaced with 2 1/2" iron pipe with cap stamped Pipe projects 2' above ground. Replaced rock cairn around base. NBT Sugar 6" S19°W 46.6 lks, scribed 1/4 BT. Pipe and BTs painted blue.

T35N R11E  
S 33  
S 4  
T34N R11E  
S498-1976

Dated at Rhineland, Wis., this 12th day of May, 1976

Signature Philip T. Hansen Title Registered Land Surveyor Registration No. S-498  
(County Surveyor, Registered Land Surveyor, or other duly authorized official)

Office of Register of Deeds, County of Langlade, I hereby certify that the within instrument was filed in this office for record on the \_\_\_\_\_ day of \_\_\_\_\_, 19\_\_\_\_ at \_\_\_\_\_ o'clock \_\_\_\_\_ M.

(Register of Deeds)

By \_\_\_\_\_ Deputy