

CERTIFIED LAND CORNER RESTORATION

Index No. A-3

State of Wisconsin }
County of Langlade } ss.

I Philip T. Hansen, do hereby certify that on the 2nd day of May, 19 80, I found evidence of the Quarter corner of Sections 31 and 6 Township 35-34, North, Range 11 East, Fourth Principal Meridian, as described hereon; and that from this evidence I established a new monument and accessories as described hereon to perpetuate the original location of this corner.

Resident witnesses:

Glen Barker

Jim Claflin

Herb Wagoner

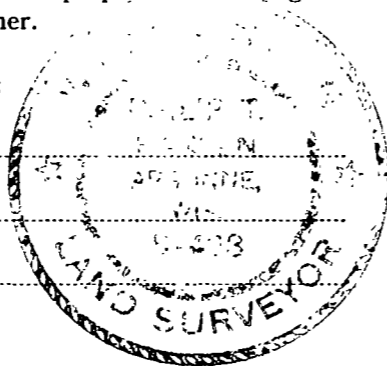

FORM 985 H. C. MILLER CO., MILWAUKEE

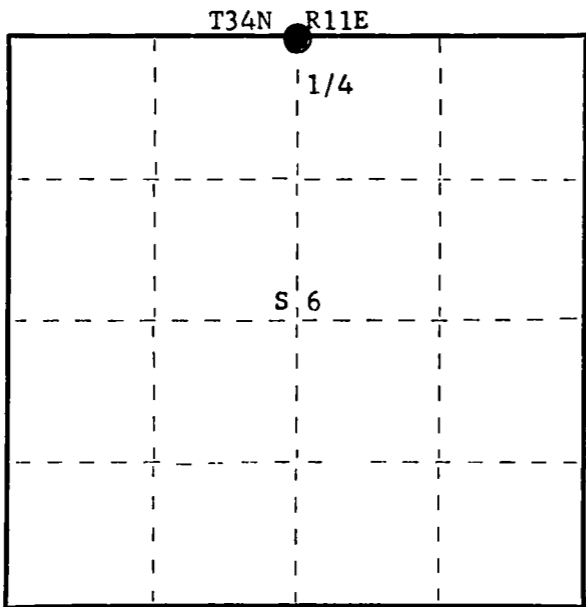

○ = Corner monument restored.

History of original corner establishment: Original corner established by Hiram C. Fellows, Deputy Surveyor, in 1859 from which Cedar 15" bears S60°W 20 links and White Birch 11" bears N40°W 10 links.
H.C. Hall recovered this corner in 1930 which he identified by the original marks on the birch and a post set by B.F. Dorr (Dorr had no notes on this corner).
Hall set a new iron pipe from the original birch BT. Scribed a cedar post and marked NBT's - Hemlock 11" S2°E 27-1/2 links; Hemlock 20" N54-1/2°W 54.7 links; original Birch 26" N40°W 10 links.

Description of corner evidence found:

Recovered an old 1" iron pipe on old N-S 1/4 line fence. Also a 6" square cedar post set by H.C. Lawrence, Registered Land Surveyor, scribed 1/4S S31 T35N 1/4S R11E. While digging in old pipe hole, we uncovered two old post points.
Recovered original birch 26" N40°W 10 links, now a decayed stump.
Hemlock 11" S8°E 27.5 links, decayed stump.

Description of monument and accessories I established to perpetuate the original location of this corner.

Set a 2-1/2" Berntsen A-1 Federal Monument in place of old pipe.

Monument projects 6" above ground. Cap stamped:

Marked NBT's - Sugar 6" S80°W 21.15 feet
Sugar 8" N33°W 19.18 feet
Cedar 9" S48°E 41.0 feet
all scribed 1/4 BT.

S498 - 1980
T35N R11E
1/4 S+31
S+6
T34N R11E

Dated at Rhineland, Wis., this 2nd day of May, 19 80

Signature Philip T. Hansen Title Registered Land Surveyor Registration No. S-498
(County Surveyor, Registered Land Surveyor, or other duly authorized official)

Office of Register of Deeds, County of Langlade, I hereby certify that the within instrument was filed in this office for record on the _____ day of _____, 19 _____ at _____ o'clock _____ M.

(Register of Deeds)

By _____ Deputy