

CERTIFIED LAND CORNER RESTORATION

Index No. A-4

State of Wisconsin }  
County of Langlade } ss.

I Philip T. Hansen, do hereby certify that on the 8th day of May, 1980, I ~~found~~ established ~~at~~ the E 1/16 corner of Sections 31 and 6 Township 35-34, North, Range 11 East, Fourth Principal Meridian, as described hereon; and that from this evidence I established a new monument and accessories as described hereon to perpetuate the original location of this corner.

Resident witnesses:

Glen Barker

Jim Claflin

Herb Wagoner

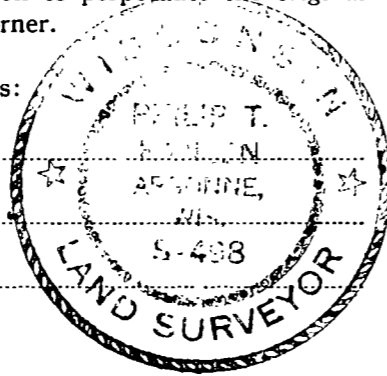

FORM 965 H. C. MILLER CO., MILWAUKEE

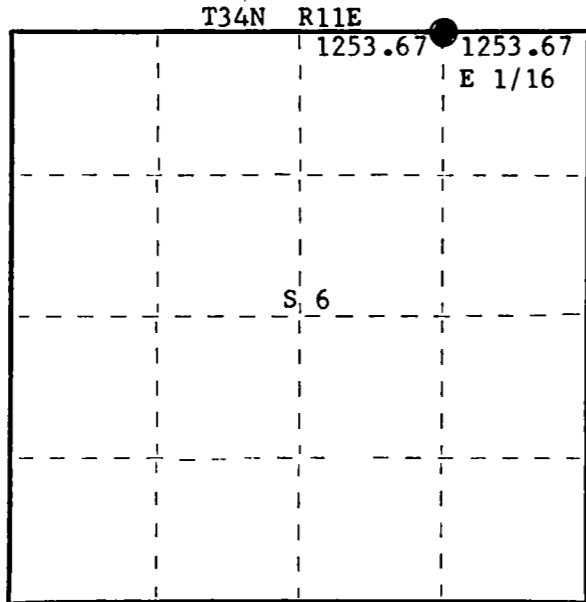

○ = Corner monument restored.

History of original corner establishment:

Description of corner evidence found:

No evidence of any corner recovered.

Corner established by traverse and computations. Ran traverses from section corner 31, 32, 5 and 6 to 1/4 corner between sections 31 and 6. Computed distance is 2507.34' at bearing S 89° 15' 02" W. Set the E 1/16 at 1253.67 feet intermediate.

Description of monument and accessories I established to perpetuate the original location of this corner.

Set a 1-1/2" iron pipe with brass cap for E 1/16 corner.

Monument projects 18" above ground. Cap stamped:

Marked NBT's -  
Sugar 6" S48°E 12.85'  
Sugar 4" N20°W 27.25'  
both scribed 1/16 BT.

S498  
T35N R11E  
E 1/16 S 31  
S 6  
T34N R11E  
1980

Dated at Rhineland, Wis., this 30th day of May, 1980

Signature: Philip T. Hansen Title Registered Land Surveyor Registration No. S-498  
(County Surveyor, Registered Land Surveyor, or other duly authorized official)

Office of Register of Deeds, County of Langlade, I hereby certify that the within instrument was filed in this office for record on the \_\_\_\_\_ day of \_\_\_\_\_, 19\_\_\_\_ at \_\_\_\_\_ o'clock \_\_\_\_\_ M.

(Register of Deeds)

By \_\_\_\_\_ Deputy