

CERTIFIED LAND CORNER RESTORATION

Index No. H-1
34-11

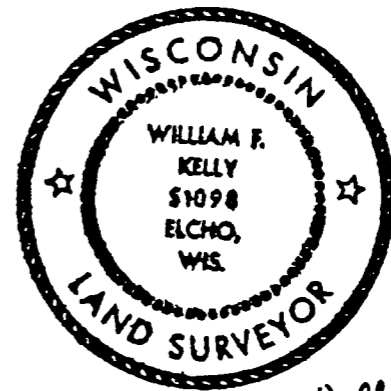

William F. Kelly

State of Wisconsin }
County of LANGLADE } ss.

I WILLIAM F. KELLY, do hereby certify that on the 21ST day of NOVEMBER, 1975, I found evidence of the SECTION corner of SECTION 36.31.1 & 6 Township 34, North, Range 10 E & 11 E, Fourth Principal Meridian, as described hereon; and that from this evidence I established a new monument and accessories as described hereon to perpetuate the original location of this corner.

History of original corner establishment:

Description of corner evidence found:
LOCATED SECTION COR. $\frac{36}{16}$ T.35N. R.10E. - R.11E.
T.34N. R.10E. - R.11E.
EXISTING 4" PIPE WITH CONC. BENT OVER WITH 1/2 OF BRASS CAP MISSING.

Resident witnesses:
.....
.....
.....

FORM 0015 W. E. MILLER CO., MILWAUKEE

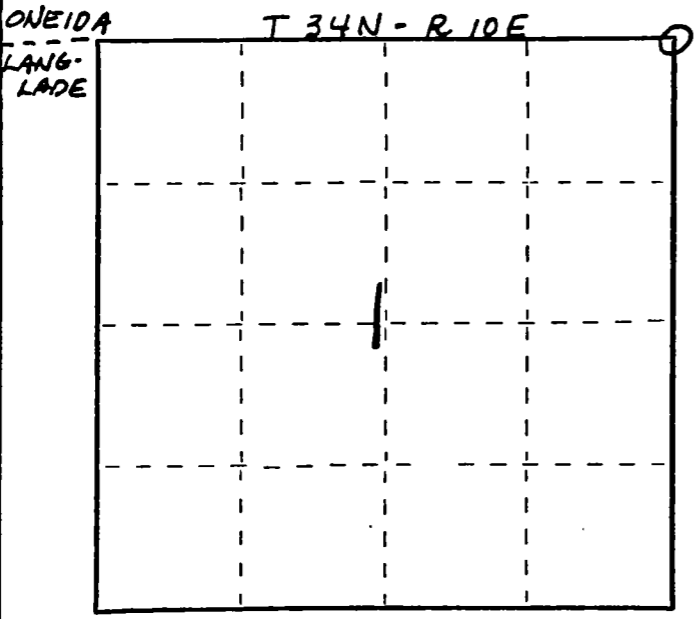

○ = Corner monument restored.

Description of monument and accessories I established to perpetuate the original location of this corner.

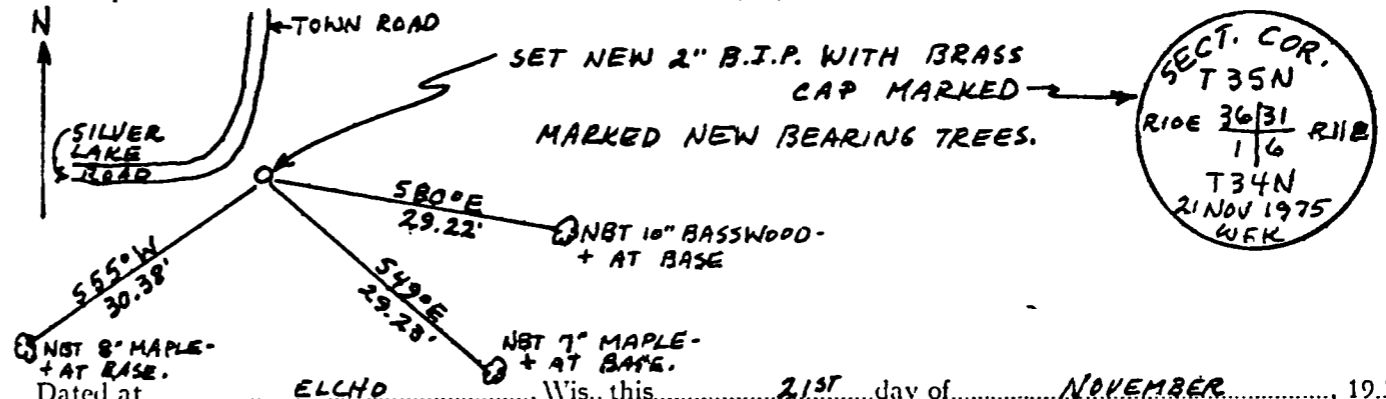

Dated at ELCHO, Wis., this 21ST day of NOVEMBER, 1975.

Signature William F. Kelly Title REGISTERED LAND SURVEYOR Registration No. 51098
(County Surveyor, Registered Land Surveyor, or other duly authorized official)

Office of Register of Deeds, County of, I hereby certify that the within instrument was filed in this office for record on the day of, 19..... at o'clock M.

(Register of Deeds)

By Deputy