

CERTIFIED LAND CORNER RESTORATION

34-10

Index No. A-14

State of Wisconsin }
County of LANGLADE } ss.

History of original corner establishment:

I, Wm. F. KELLY, do hereby certify that on the 18TH day of MAY, 1974, I found evidence of the WEST 1/16 corner of SEC. 3 & 34 Township 34 & 35, North, Range 10 EAST, Fourth Principal Meridian, as described hereon; and that from this evidence I established a new monument and accessories as described hereon to perpetuate the original location of this corner.

Description of corner evidence found:

4" x 4" SQD. STAKE W/MARKS ON 2 SIDES.



William F. Kelly

Resident witnesses:

ROBERT J. BOSS

Description of monument and accessories I established to perpetuate the original location of this corner.

SET 2" IRON PIPE W/BRASS CAP MKD.
IN CENTER OF GRASSY SWAMP.
NO TREES OR IDENTIFIABLE OBJECTS NEAR.

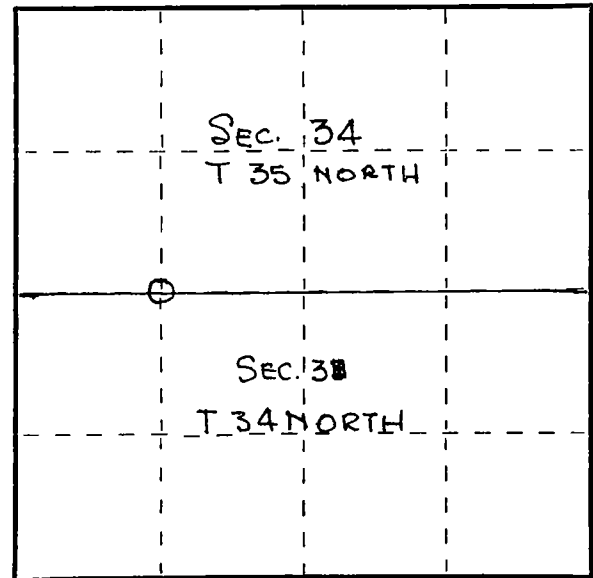
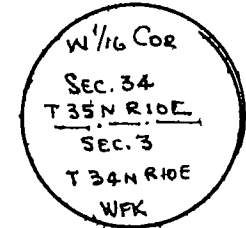

○ = Corner monument restored.

Dated at ELCHO, Wis., this 18TH day of MAY, 1974.

Signature William F. Kelly Title REG. LAND SURVEYOR Registration No. S-1098
(County Surveyor, Registered Land Surveyor, or other duly authorized official)

Office of Register of Deeds, County of _____, I hereby certify that the within instrument was filed in this office for record on the _____ day of _____, 19____ at _____ o'clock _____ M.

(Register of Deeds)

By _____ Deputy