

CERTIFIED LAND CORNER RESTORATION

Index No. A-2

State of Wisconsin }  
County of Langlade } ss.

I Raymond J. Hallisy, do hereby certify that on the 6th day of December, 19 81, I found evidence of the West 1/16 corner of Section 31 & 6 Township T35NR10E, North, Range T35NR10E, Fourth Principal Meridian, as described hereon; and that from this evidence I established a new monument and accessories as described hereon to perpetuate the original location of this corner.

Resident witnesses:

.....  
.....  
.....

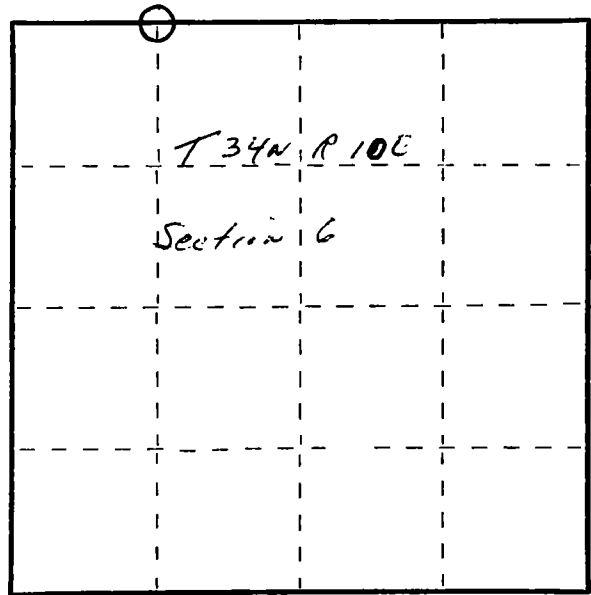

○ = Corner monument restored.

History of original corner establishment:

Corner set in the 1930 resurvey.

Description of corner evidence found:

Found stake standing, marked W1/8 6, 31  
Old BT 6" Red Pine N83W 2.7 Ft.

Description of monument and accessories I established to perpetuate the original location of this corner.

Set 1 1/2" iron pipe with brass cap  
New BT's

- 8" Hemlock S64W 9.3 Ft.
- 5" Hemlock S28W 10.8 Ft.
- 7" Red Pine N68W 9.3 Ft.

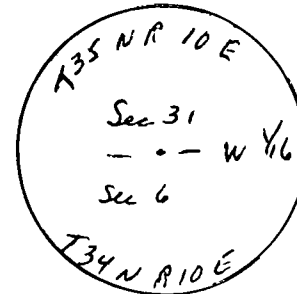

Dated at Antigo, Wis., this 6th day of December, 19 81

Signature Raymond J. Hallisy Title Land Surveyor Registration No. S-685  
(County Surveyor, Registered Land Surveyor, or other duly authorized official)

Office of Register of Deeds, County of \_\_\_\_\_, I hereby certify that the within instrument was filed in this office for record on the \_\_\_\_\_ day of \_\_\_\_\_, 19 \_\_\_\_\_ at \_\_\_\_\_ o'clock \_\_\_\_\_ M.

.....  
(Register of Deeds)

By \_\_\_\_\_ Deputy

FORM 985 H. C. MILLER CO., MILWAUKEE