

CERTIFIED LAND CORNER RESTORATION

Index No. A-21

State of Wisconsin }
 County of Langlade } ss.

I, Raymond J. Hallisy, do hereby certify that on the 7th day of March, 1981, I found evidence of the Section corner of 35, 36, 1, & 2 Township 34 & 35, North, Range 9E, Fourth Principal Meridian, as described hereon; and that from this evidence I established a new monument and accessories as described hereon to perpetuate the original location of this corner.

Resident witnesses:

History of original corner establishment:

Description of corner evidence found:

2" pipe with galvanized cap
 Old BT 14" Red pine S5E 11.66 Links

Description of monument and accessories I established to perpetuate the original location of this corner.

New BT's
 11" Red pine N84W 5'6"
 8" Red pine N2W 2'5"
 4" Hemlock S25E 10'

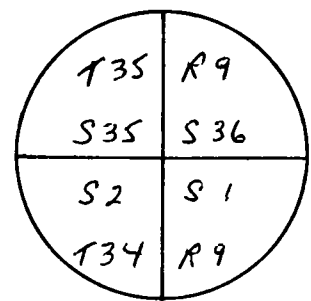

FORM 985 H. C. MILLER CO., MILWAUKEE

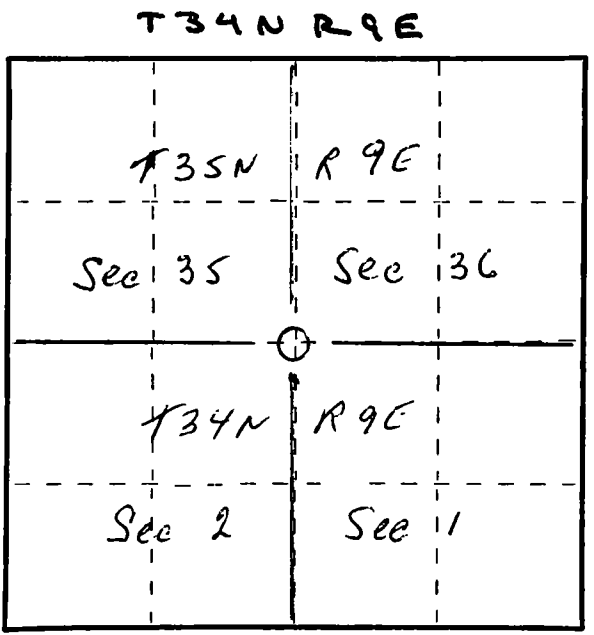

○ = Corner monument restored.

Dated at Antigo, Wis., this 7th day of March, 1981.

Signature Raymond J. Hallisy Title Reg. Surveyor Registration No. S-685
 (County Surveyor, Registered Land Surveyor, or other duly authorized official)

Office of Register of Deeds, County of _____, I hereby certify that the within instrument was filed in this office for record on the _____ day of _____, 19____ at _____ o'clock _____ M.

 (Register of Deeds)

By _____ Deputy