

CERTIFIED LAND CORNER RESTORATION

Index No. A-18

State of Wisconsin }
County of LANGLADE } ss.

History of original corner establishment:

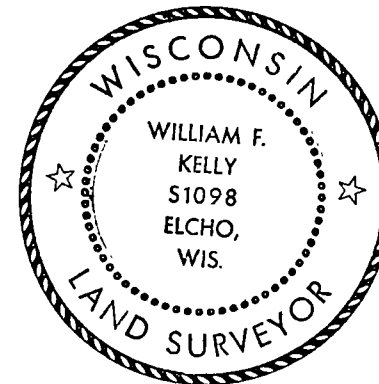

I WILLIAM F. KELLY, do hereby certify that on the 29th day of MARCH, 1979, I found evidence of the W 1/4 corner of SEC. 2 Township 33, North, Range 13 E, Fourth Principal Meridian, as described hereon; and that from this evidence I established a new monument and accessories as described hereon to perpetuate the original location of this corner.

Description of corner evidence found:

William F. Kelly

**LOCATED W 1/4 COR. ON N. SEC. LINE OF SEC. 2, T33N-R13E
FOUND 4" ALUM. CAP SET BY SPERHAKE IN 1962 FOR KIMBERLY CLARK CORP.**

Resident witnesses:

.....
.....
.....

Description of monument and accessories I established to perpetuate the original location of this corner.

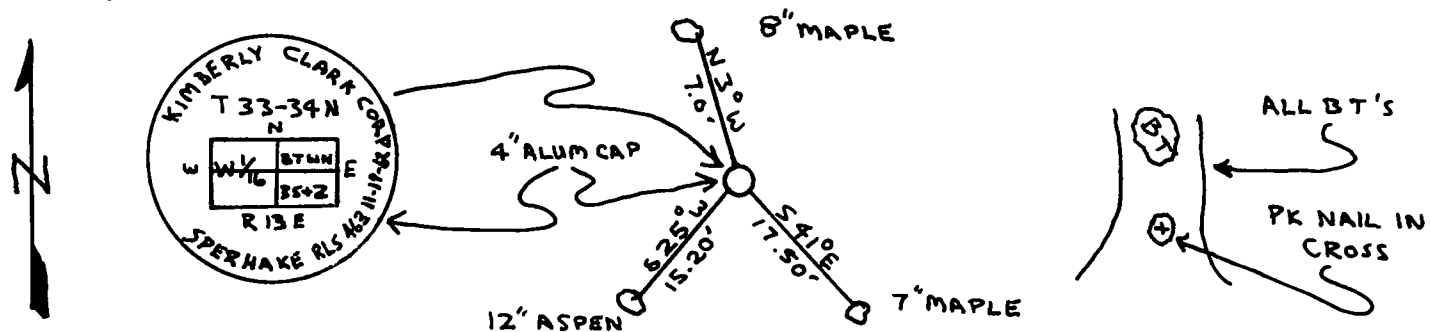
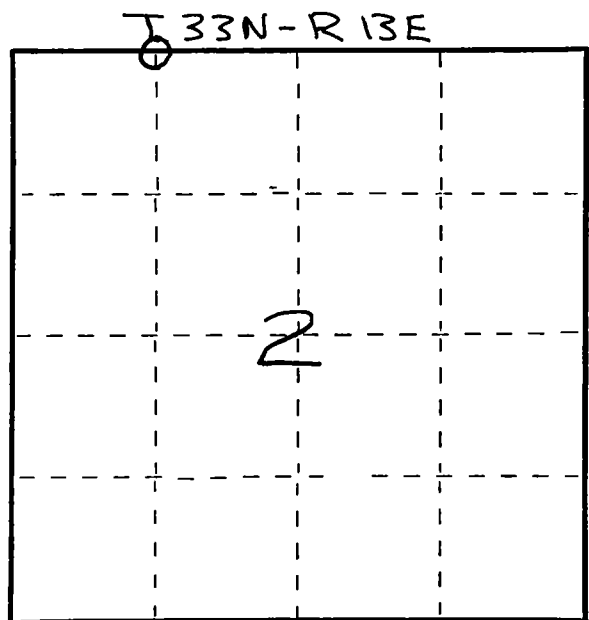

Dated at ELCHO, Wis., this 29th day of MARCH, 1979.

Signature William F. Kelly Title COUNTY SURVEYOR Registration No. S-1098
(County Surveyor, Registered Land Surveyor, or other duly authorized official)

Office of Register of Deeds, County of....., I hereby certify that the within instrument was filed in this office for record on the.....day of....., 19..... at.....o'clock..... M.

.....
(Register of Deeds)

By.....Deputy

○ = Corner monument restored.