

CERTIFIED LAND CORNER RESTORATION

34-12

Index No. ~~W 23725~~
~~V-W 25~~
~~X-33~~
W25

State of Wisconsin }
 County of LANGLADE } ss.

I RAYMOND J. HALLISY, do hereby certify that on the 7th day of JANUARY, 1966, I found evidence of the ATTACHED CORNER corner of 36 Township 34N, North, Range 12E, Fourth Principal Meridian, as described hereon; and that from this evidence I established a new monument and accessories as described hereon to perpetuate the original location of this corner.

History of original corner establishment:

- PRESENT { 1. HEADER CORNER ON EAST SEC. LINE ON SOUTH SHORE OF PICKEREL LAKE
 SEE SKETCH { 2. E 1/4 CORNER
 3. CENTER-NORTH 1/16 CORNER

Description of corner evidence found:

See attached Record of Survey #10253

Resident witnesses:

ROBERT BECKER - SHAWANO, WISC
EUGENE ZEUSKE - " "
FRANCIS QUINN - " "

Description of monument and accessories I established to perpetuate the original location of this corner.

(A) ESTABLISH 1/8 CORNER BETWEEN E 1/4 CORNER AND M.C. 0

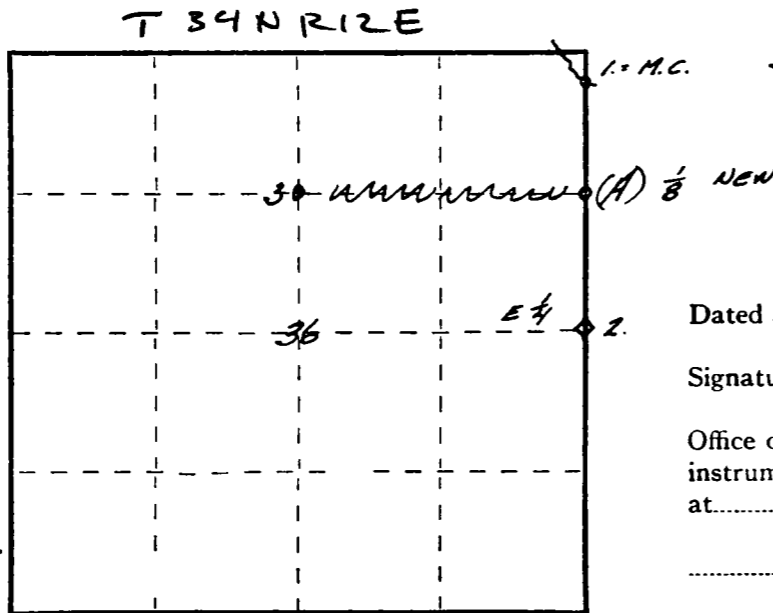

B W W W W FROM TRUE LINE N 1/8 ON EAST SECTION LINE AND CTR N 1/16 CORNER ON N-S QUARTER LINE

ALL MEASUREMENTS, DISTANCES, BEARINGS AND FIELD WORK ARE DESCRIBE ON ATTACHED COPIES.

Dated at ANTIGO, Wis., this 3 day of MAY, 1966.

Signature Raymond J. Hallisy Title Antigo Family - W 25 Registration No. 5-685
 (County Surveyor, Registered Land Surveyor, or other duly authorized official)

Office of Register of Deeds, County of _____, I hereby certify that the within instrument was filed in this office for record on the _____ day of _____, 19____ at _____ o'clock _____ M.

(Register of Deeds)

By _____ Deputy

○ = Corner monument restored.

FORM 985 M. C. MILLER CO., MILWAUKEE