

CERTIFIED LAND CORNER RESTORATION

34-12

Index No. X-20

State of Wisconsin }
County of LANGLADE } ss.

I WM. F. KELLY, do hereby certify that on the 22ND day of JULY, 1974, I found evidence of the E 1/16 COR ON E-W 1/4 LINE corner of SECTION 35 Township 34, North, Range 12 EAST, Fourth Principal Meridian, as described hereon; and that from this evidence I established a new monument and accessories as described hereon to perpetuate the original location of this corner.

Resident witnesses:

H. L. BALL (ASST. ON HUTCHINSON SURVEY SEC. 35)

FORM 985 H. C. MILLER CO., MILWAUKEE

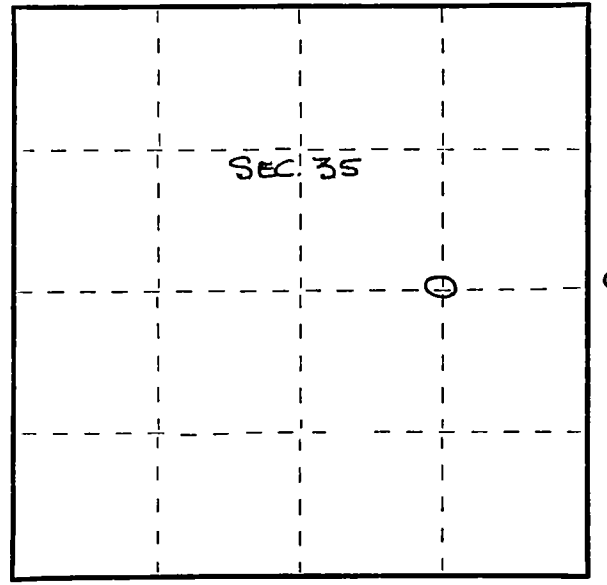

○ = Corner monument restored.

History of original corner establishment:

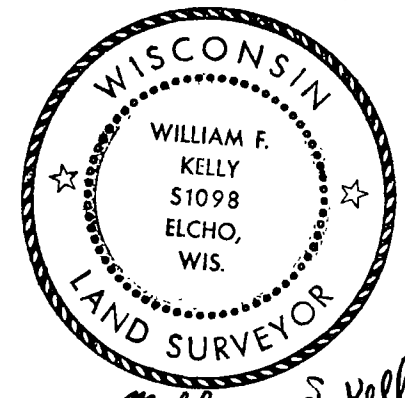

William F. Kelly

Description of corner evidence found:

FOUND 1 1/2" IRON PIPE 6" UNDERGROUND SET BY HUTCHINSON. PIPE IN GOOD CONDITION IN ROAD.

Description of monument and accessories I established to perpetuate the original location of this corner.

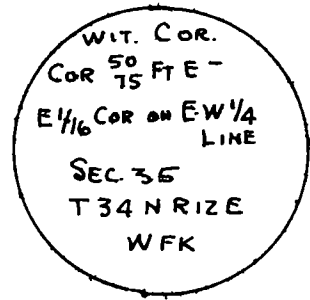
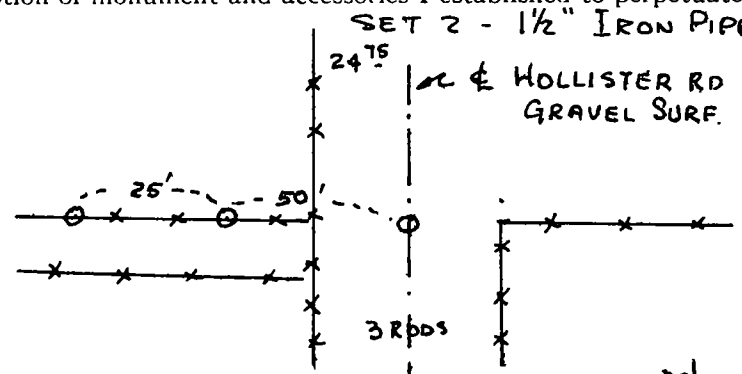

Dated at ELCHO, Wis., this 22nd day of July, 1974.

Signature William F. Kelly Title Reg. Land Surveyor Registration No. S-1098
(County Surveyor, Registered Land Surveyor, or other duly authorized official)

Office of Register of Deeds, County of _____, I hereby certify that the within instrument was filed in this office for record on the _____ day of _____, 19____ at _____ o'clock _____ M.

(Register of Deeds)

By _____ Deputy