

CERTIFIED LAND CORNER RESTORATION

Index No. **A-20**

38-12

State of Wisconsin }
County of LANGLADE } ss.

I, WILLIAM F. KELLY, do hereby certify that on the 19TH day of APRIL, 1976, I found evidence of the E 1/8 SECTION corner of SECTIONS 35 & 2 Township 33+34, North, Range 12E, Fourth Principal Meridian, as described hereon; and that from this evidence I established a new monument and accessories as described hereon to perpetuate the original location of this corner.

Resident witnesses:

C. CRUGER

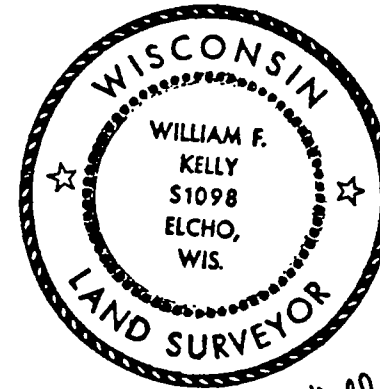

William F. Kelly
22 April 1976

Description of corner evidence found:

1 1/2" BLACK IRON PIPE IDENTIFIED BY RESIDENT WITNESS AS THE 1/8 COR.

Description of monument and accessories I established to perpetuate the original location of this corner.

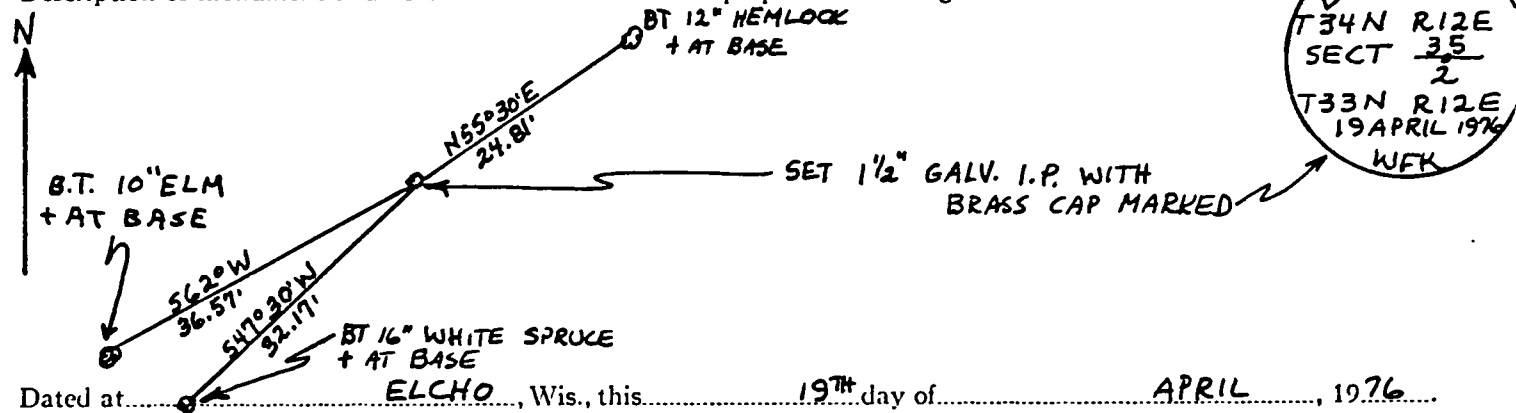

Dated at ELCHO, Wis., this 19TH day of APRIL, 1976.

Signature William F. Kelly Title REGISTERED LAND SURVEYOR Registration No. 5109B
(County Surveyor, Registered Land Surveyor, or other duly authorized official)

Office of Register of Deeds, County of _____, I hereby certify that the within instrument was filed in this office for record on the _____ day of _____, 19____ at _____ o'clock _____ M.

(Register of Deeds)

By _____ Deputy

FORM 985 W. C. MILLER CO., MILWAUKEE

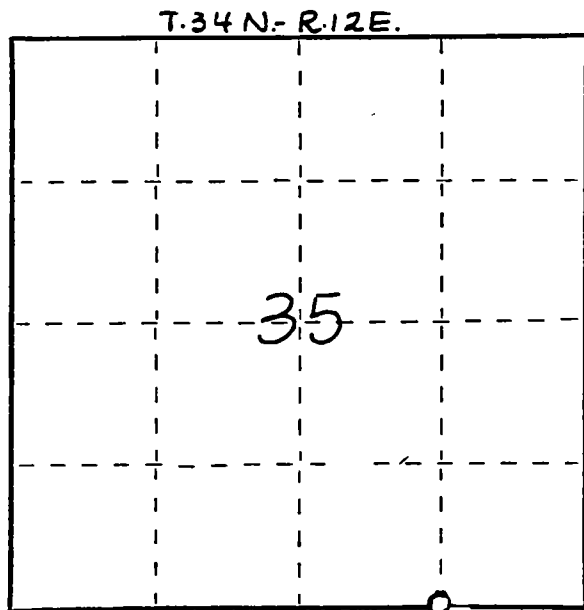

○ = Corner monument restored.