

CERTIFIED LAND CORNER RESTORATION

34-12

Index No. W-5

State of Wisconsin }  
County of Lanlade } ss.

History of original corner establishment:  
**None**

I Raymond J. Hallisy, do hereby certify that on the 12 th day of July, 19 69, I ~~found~~ ~~evidence of the established the N. 1/16~~ corner of ~~section 31-32~~ section 31 Township 34, North, Range 12 East, Fourth, Principal Meridian, as described hereon; and that from this evidence I established a new monument and accessories as described hereon to perpetuate the original location of this corner.

Description of corner evidence found:

**None - New survey:** Run random line North 0°, Var 1½° E from East ¼ corner of sec 31 to N.E. corner of sed. 31 T34 N R 12 E. Length of random line 41 chains and 99.5 links. Fell 81.3 links east of corner. Corrected random line and set N 1/16 20 chains and 98.25 links.

Resident witnesses:

Jerry Weix  
Gerald Kryka

Description of monument and accessories I established to perpetuate the original location of this corner.

Set 2 inch iron pipe with brass cap.  
Bearing trees marked with BT  
Red pine 15" N70° E 2ft. 10 in.  
Red pine 15 " N 65° W 37ft. 5in.

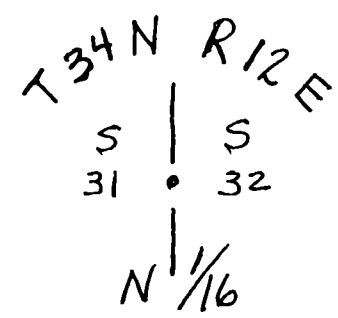

FORM 985 H. C. MILLER CO., MILWAUKEE

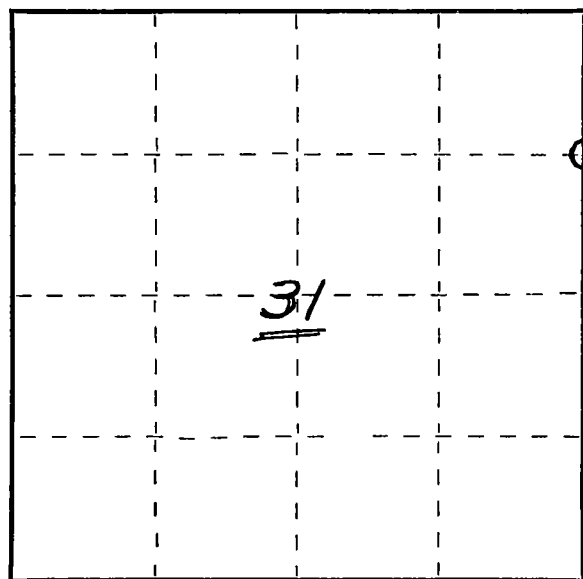

○ = Corner monument restored.

Dated at July Antigo, Wis., this 12 day of July, 1969

Signature Raymond J. Hallisy Title Reg. Land Surveyor Registration No. S-685  
(County Surveyor, Registered Land Surveyor, or other duly authorized official)

Office of Register of Deeds, County of \_\_\_\_\_, I hereby certify that the within instrument was filed in this office for record on the \_\_\_\_\_ day of \_\_\_\_\_, 19\_\_\_\_ at \_\_\_\_\_ o'clock \_\_\_\_\_ M.

(Register of Deeds)

By \_\_\_\_\_ Deputy