

CERTIFIED LAND CORNER RESTORATION

34-12  
Index No. Y-4

State of Wisconsin }  
County of Langlade } ss.

History of original corner establishment:

I Raymond J. Hallisy, do hereby certify that on the 10th day of May, 1969, I found evidence of the SE 1/16 corner of Section 31 Township 34, North, Range 12E, Fourth, Principal Meridian, as described hereon; and that from this evidence I established a new monument and accessories as described hereon to perpetuate the original location of this corner.

Description of corner evidence found:

Found old stake down point in ground in a rock mound old BT Jack Pine 14" S46W 10Ft.

Resident witnesses:

.....  
.....  
.....

Description of monument and accessories I established to perpetuate the original location of this corner.

Set 2" pipe with brass cap  
B.T.'S to corner  
White pine 11" N60W 10Ft. 10 inches  
Jack Pine 9" S60E 11Ft. 8 inches  
B.T.'s faced at base of tree and scribed BT

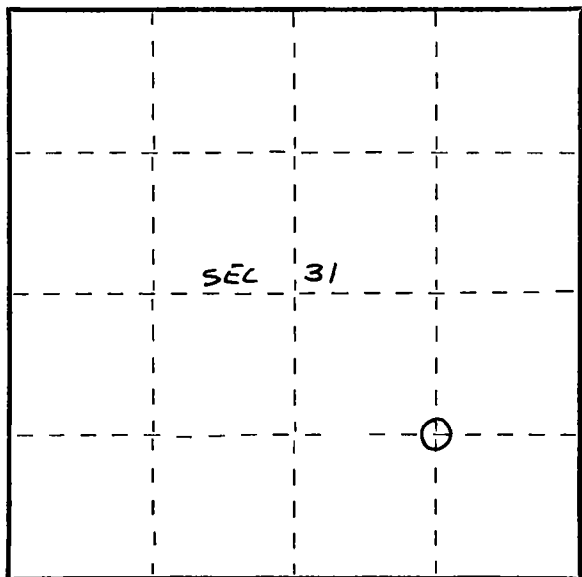
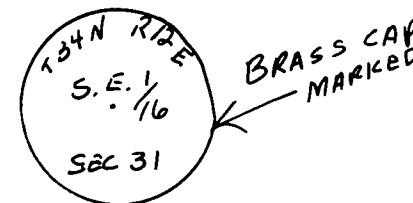

○ = Corner monument restored.

Dated at Antigo, Wis., this 10th day of May, 1969

Signature Raymond J. Hallisy Title Reg. Land Surveyor Registration No. S-685  
(County Surveyor, Registered Land Surveyor, or other duly authorized official)

Office of Register of Deeds, County of....., I hereby certify that the within instrument was filed in this office for record on the.....day of....., 19..... at.....o'clock..... M.

.....  
(Register of Deeds)

By.....Deputy