

LANGLADE COUNTY U.S. PUBLIC LAND CORNER RESTORATION

The West quarter corner of Section 28, T. 34 N., R. 12 E., Langlade County, WI.

Corner was: (check all that apply)

3412292000

- Restored through acceptance of an obliterated evidence location.
- Restored through acceptance of a found perpetuated location.
- Determined to be lost and re-established through proportionate methods.
Show bearings and distances to PLSS corners used for proportioning, and show original distances).
- Restored/recovered/re-established in a location that differs from a previously established position.
(Show difference in plan view below).
- Check here if addition information is shown on the reverse side of this form.

Describe record evidence, recovered physical evidence, occupational evidence, testimonial evidence and all other evidence considered in the recovery/restoration of the corner.

The original corner was established in 1865 by James L. Nowlin. Original bearing trees: spruce, 8", N10°W, 12 lks. (7.92'), and a cedar, 6", S13°E, 6 lks. (3.96')

In 1938, A.J. Lytle surveyed in Section 28, measured the E-W 1/4 line as 78.01 ch. (5148.66 ft), and described the corner as "...old post - BT- blazed but no iron marks". 09/24/99 Dave Tlusty, Dean Williams, after tying into the N1/4, NE, E1/4 and SE corners of Section 28 with GPS equipment, we computed search area coordinates and found a 14" cedar, blazed with old axe marks clearly visible on NW side of tree. We tore up a big area on the NW side of the cedar, looking for an old post point. Found nothing. Being that this tree fits Lytle's section subdivision, it has old blazing as he describes and we have no other information to go by, I accepted this tree as the original cedar and set a monument for the corner at the original bearing and distance from it.

Physical description of the monument set:

Set a 2" x 42" aluminum pipe monument with 3 1/4" aluminum cap for the corner.
Set a white vinyl sign post 0.5' north of the corner monument.

Describe the accessories used to perpetuate the corner. Include a plan view drawing and accessories found/set. Describe measuring point on bearing trees. Show any topographic features that would aid in future recovery of the corner.

LEGEND

- Bearing trees are measured to a nail in a low blaze on the side of the tree shown.
- BT's painted blue.
- Tie bearings magnetic with hand compass.

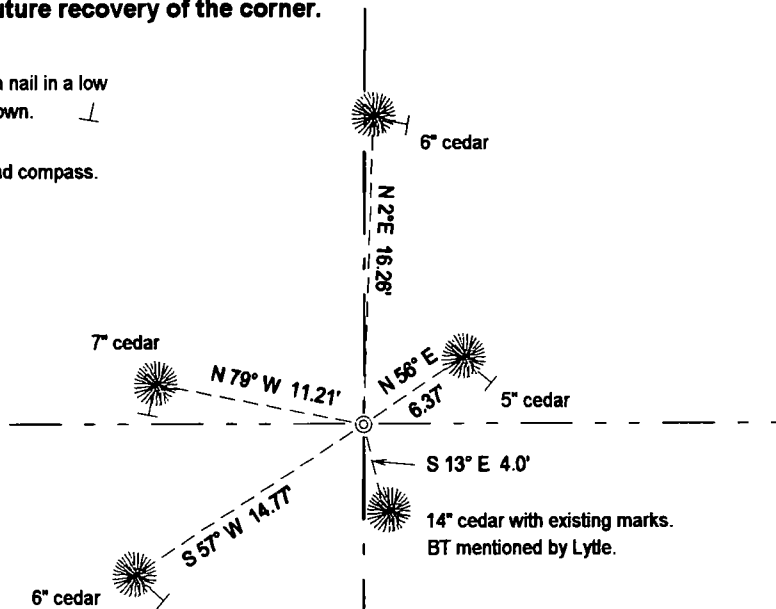

Field book FB17-40

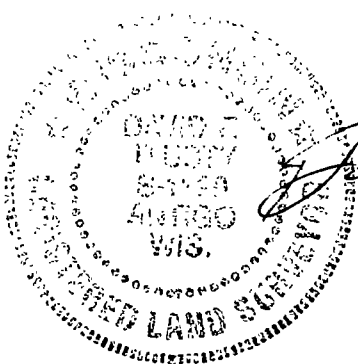

David E. Tlusty
1/18/2000

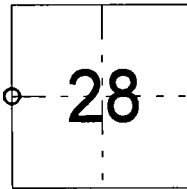

○ = corner perpetuated
The West Quarter corner of Section 28, T. 34 N., R. 12 E., Langlade County, WI

I, David E. Tlusty, Registered Land Surveyor, as Langlade County Surveyor, certify that the corner location on this record was determined by me and that this U.S. Public Land Survey Monument Record is correct to the best of my knowledge and belief.

Index No. T9 34-12