

CERTIFIED LAND CORNER RESTORATION

Index No. V-7

State of Wisconsin }
County of Lanlgade } ss.

I Raymond J. Hallisy, do hereby certify that on the 13th day of April, 1980, I found evidence of the 1/4 corner of 29 & 32 Township 34, North, Range 12E, Fourth Principal Meridian, as described hereon; and that from this evidence I established a new monument and accessories as described hereon to perpetuate the original location of this corner.

Resident witnesses:

.....
.....
.....

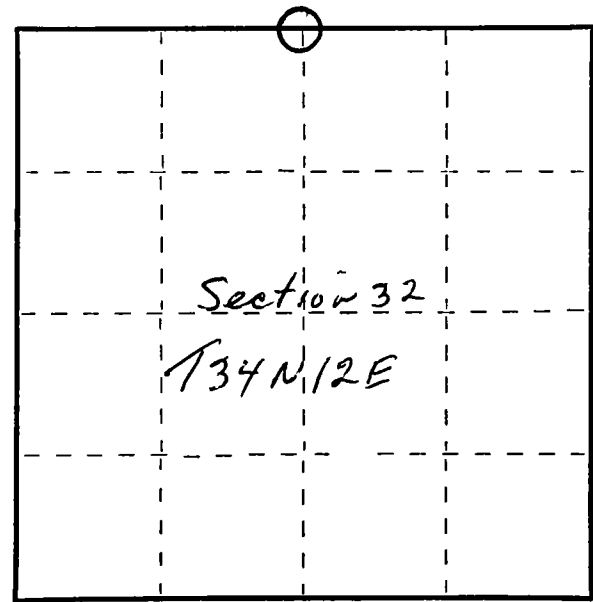

○ = Corner monument restored.

History of original corner establishment:

Corner set in the 1930's by Chas. Berth.

Description of corner evidence found:

6" wood post 6' long Marked 1/4S 29, 32
Old BT Stump S60E 10'9"

Description of monument and accessories I established to perpetuate the original location of this corner.

Set 2" iron pipe with brass cap alongside post.

New BT's

11"	Jack pine Pine	S36E	11'8"
9"	Black Spruce	S42W	12'4"
8"	Black Spruce	N25W	10'10"

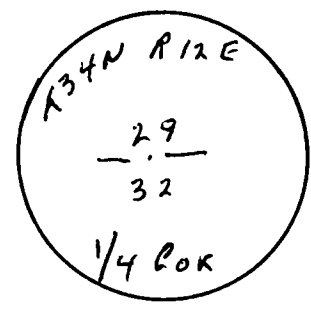

Dated at Antigo, Wis., this 13th day of April, 1980.

Signature Raymond J. Hallisy Title Land Surveyor Registration No. S-685
(County Surveyor, Registered Land Surveyor, or other duly authorized official)

Office of Register of Deeds, County of _____, I hereby certify that the within instrument was filed in this office for record on the _____ day of _____, 19____ at _____ o'clock _____ M.

.....
(Register of Deeds)

By.....Deputy

FORM 985 H C MILLER CO., MILWAUKEE