

CERTIFIED LAND CORNER RESTORATION

34-12

Index No. 4-13

State of Wisconsin }
County of LANGLADE } ss.

I, ROBERT J. POSS, do hereby certify that on the 4TH day of JUNE, 19 68, I found evidence of the SOUTH 1/16 COR corner of SECS 27 & 28 Township 34, North, Range 12 EAST, Fourth, Principal Meridian, as described hereon; and that from this evidence I established a new monument and accessories as described hereon to perpetuate the original location of this corner.

History of original corner establishment:

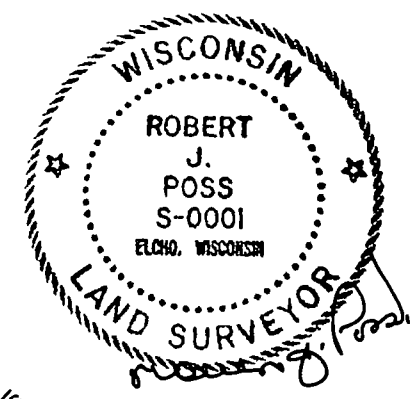

Description of corner evidence found:

FOUND PICKET & HOLE WHERE STAKE HAD BEEN. SOME WOOD PCS. FROM SQUARED STAKE FOUND WHILE DIGGING

Resident witnesses:

.....
.....
.....

Description of monument and accessories I established to perpetuate the original location of this corner.

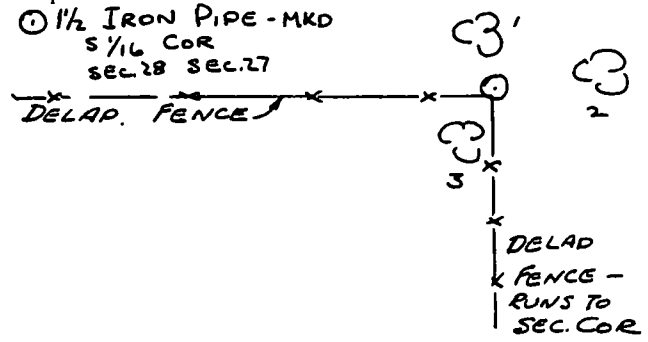

- 1 = BALSAM 4 N 13 1/2 W 5.8
- 2 = SPRUCE 12 N 51 3/4 E 25.0
- 3 = SPRUCE 4 S 14 W 4.5

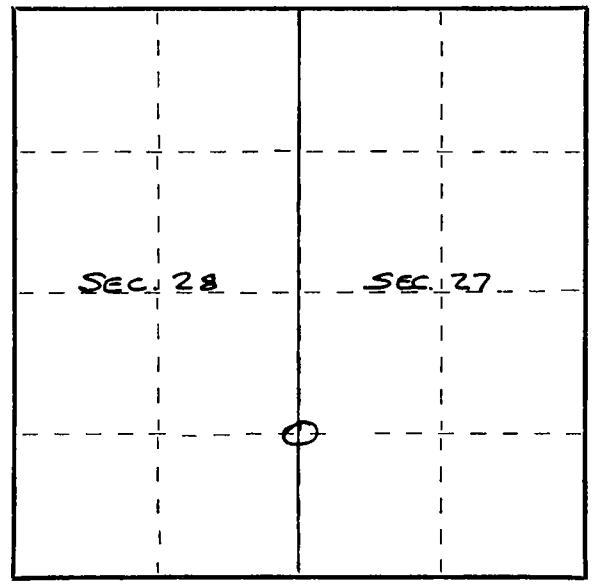

Dated at ELCHO, Wis., this 4TH day of JUNE, 19 68.

Signature Robert J. Poss, Title REG. LAND SURVEYOR Registration No. 5-1
(County Surveyor, Registered Land Surveyor, or other duly authorized official)

Office of Register of Deeds, County of _____, I hereby certify that the within instrument was filed in this office for record on the _____ day of _____, 19 _____ at _____ o'clock _____ M.

(Register of Deeds)

By _____ Deputy

○ = Corner monument restored.

FORM 985 M. C. MILLER CO., MILWAUKEE