

CERTIFIED LAND CORNER RESTORATION

34-12

Index No. V-16

State of Wisconsin }
County of LANGLADE } ss.

History of original corner establishment:

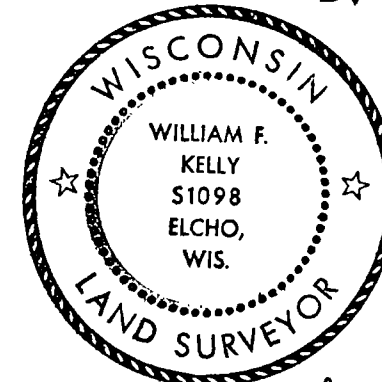

William F. Kelly 24 July 1974

I, W. F. KELLY, do hereby certify that on the 24TH day of JULY, 1974, I found evidence of the EAST 1/8 corner of SECS. 27 & 34 Township 34, North, Range 12 EAST, Fourth Principal Meridian, as described hereon; and that from this evidence I established a new monument and accessories as described hereon to perpetuate the original location of this corner.

Description of corner evidence found:

LOCATED WITNESS TREES; WITNESSES INDICATED CORNER HAD BEEN REMOVED IN BUILDING SNOW MOBILE TRAILS FOUND HOLE BETWEEN WITNESS TREES.

Resident witnesses:

H. L. BALL (ASST. ON PREV. SURVEY W/ HUTCHINSON)

MRS. Y. WOLHAUPT

Description of monument and accessories I established to perpetuate the original location of this corner.

SET 1/2" PIPE W/ BRASS CAP MKD.

**OLD BTS SCRIBED BUT NOT LEGIBLE
CEDAR 6 N 31 E 7.6
CEDAR 5 S 31 W 7.6**

**NEW BTS - NBT BLAZED CHEST HIGH & SCRIBED NBT
BLAZED BASE & MKD +
W. PINE 22 S 29 1/2 E 5.5
CEDAR 10 N 85 W 7.85**

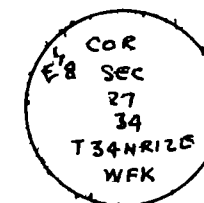

FORM 985 H. C. MILLER CO., MILWAUKEE

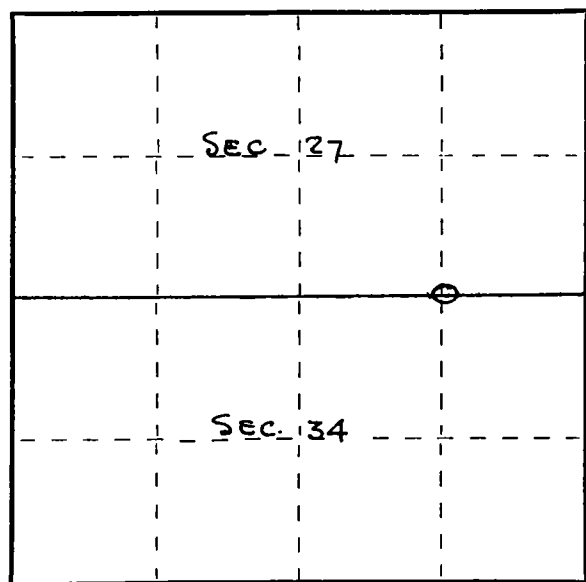

○ = Corner monument restored.

Dated at ELCHO, Wis., this 24TH day of JULY, 1974.

Signature William F. Kelly Title REG. LAND SURVEYOR Registration No. S-1098
(County Surveyor, Registered Land Surveyor, or other duly authorized official)

Office of Register of Deeds, County of _____, I hereby certify that the within instrument was filed in this office for record on the _____ day of _____, 19____ at _____ o'clock _____ M.

(Register of Deeds)

By _____ Deputy