

CERTIFIED LAND CORNER RESTORATION

State of Wisconsin }
County of LANGLADE } ss.

I W. F. KELLY, do hereby certify that on the 15TH day of JULY, 1974, I found evidence of the SECTION corner of SECS. 26-27-34-35 Township 34, North, Range 12 EAST, Fourth Principal Meridian, as described hereon; and that from this evidence I established a new monument and accessories as described hereon to perpetuate the original location of this corner.

Resident witnesses:

H. L. BALL (ASST'D HUTCHINSON ON SURVEY)

MRS. V. WOLHAUPT

FORM 985 H. C. MILLER CO., MILWAUKEE

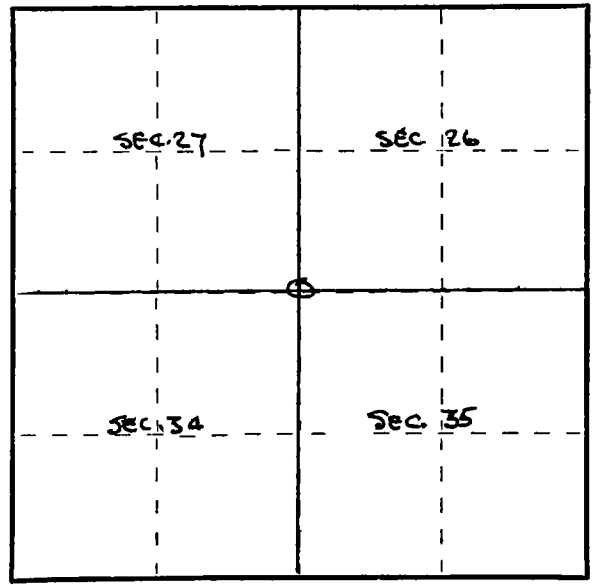

○ = Corner monument restored.

History of original corner establishment:

Description of corner evidence found:
LOCATED SQ'D. POST NEXT TO 1 1/2" IRON PIPE
ALSO 2 ORIGINAL BLAZED TREES
HUTCHINSON SURVEY CIRCA 1930



William F. Kelly
15 July 1974

Description of monument and accessories I established to perpetuate the original location of this corner.

SET 1 1/2" IRON PIPE W/ BRASS CAP NEXT TO WOOD POST.
2" REMAINS OLD PINE STUMP
SCRIBED 27 BT
N27W 19.5
DEAD TREE
W/SCRIBED 27 BT
54 3/4 W 9.8
2" IRON PIPE W/ BRASS CAP
N87E BLAZED CHEST HIGH
& BRSC
3 CEDAR 9 546 E 29.4
SCRIBED N8T.
3 CEDAR 14 526 1/2 W 18.3
MKD N8T

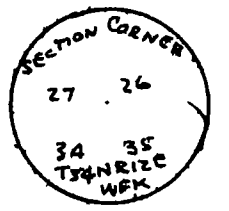

Dated at ELCHO, Wis., this 15TH day of JULY, 1974.

Signature William F. Kelly Title REG. LAND SURVEYOR Registration No. 5-1098
(County Surveyor, Registered Land Surveyor, or other duly authorized official)

Office of Register of Deeds, County of _____, I hereby certify that the within instrument was filed in this office for record on the _____ day of _____, 19____ at _____ o'clock _____ M.

(Register of Deeds)

By _____ Deputy