

CERTIFIED LAND CORNER RESTORATION

34-12

Index No. Y-19

State of Wisconsin }
County of LANGLADE } ss.

History of original corner establishment:

I W^m F. KELLY, do hereby certify that on the 19TH day of JULY, 1974, I found evidence of the WEST 1/8 corner of SECS. 26 & 35 Township 34.1, North, Range 12 EAST, Fourth Principal Meridian, as described hereon; and that from this evidence I established a new monument and accessories as described hereon to perpetuate the original location of this corner.

Description of corner evidence found:

FOUND PIPE SET BY HUTCHINSON AT 3-WAY FENCE COR.
ALSO LINE OF BLAZED TREES TO THE SOUTH



William F. Kelly
19 July 1974

Resident witnesses:

H.L. BALL (SURVEYOR ASST. M. HUTCHINSON)

ROLAND JANSEN

V. WOLHAUPT

Description of monument and accessories I established to perpetuate the original location of this corner.

SET 1 1/2" IRON PIPE W/ BRASS CAP MKD.

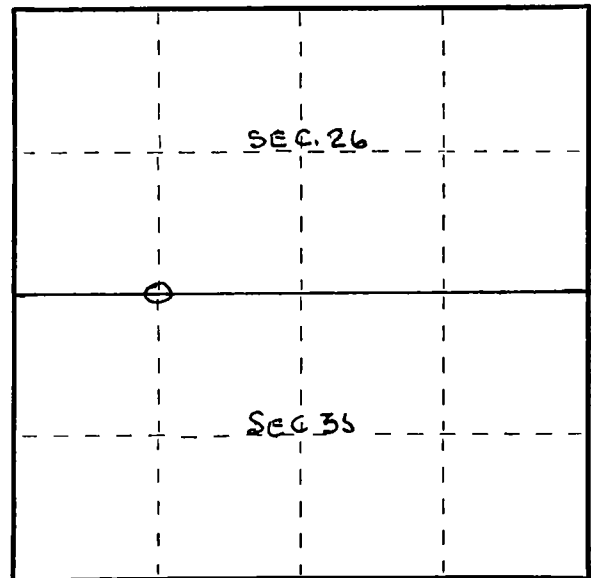
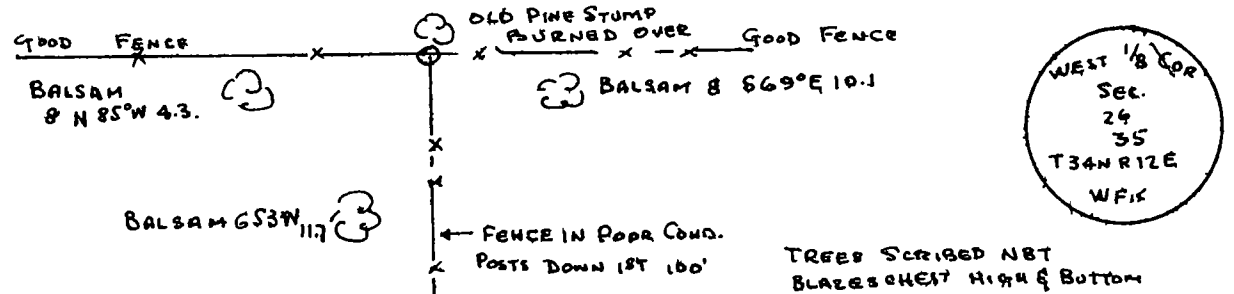

○ = Corner monument restored.

Dated at ELCHO, Wis., this 19TH day of JULY, 1974

Signature _____ Title REG. LAND SURVEYOR Registration No. S-1098
(County Surveyor, Registered Land Surveyor, or other duly authorized official)

Office of Register of Deeds, County of _____, I hereby certify that the within instrument was filed in this office for record on the _____ day of _____, 19____ at _____ o'clock _____ M.

(Register of Deeds)

By _____ Deputy