

CERTIFIED LAND CORNER RESTORATION

State of Wisconsin }
County of LANGLADE } ss.

History of original corner establishment:

I WM F. KELLY, do hereby certify that on the 22ND day of JULY, 1974, I found evidence of the E 1/8 corner of SECS 26 & 35 Township 34, North, Range 12 EAST, Fourth Principal Meridian, as described hereon; and that from this evidence I established a new monument and accessories as described hereon to perpetuate the original location of this corner.

Description of corner evidence found:
FOUND 1 1/2" IRON PIPE AT SURFACE OF ROAD SET BY HUTCHINSON.

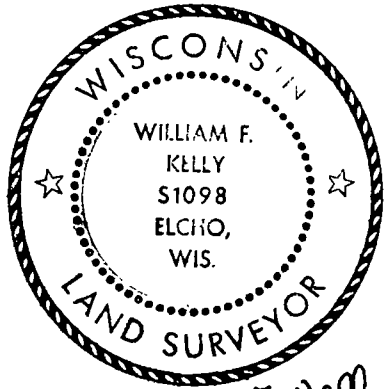

William F. Kelly
22nd July 1974

Resident witnesses:

H.L. BALW (ASST. ON HUTCHINSONS SURVEY SEC. 35)

Description of monument and accessories I established to perpetuate the original location of this corner.

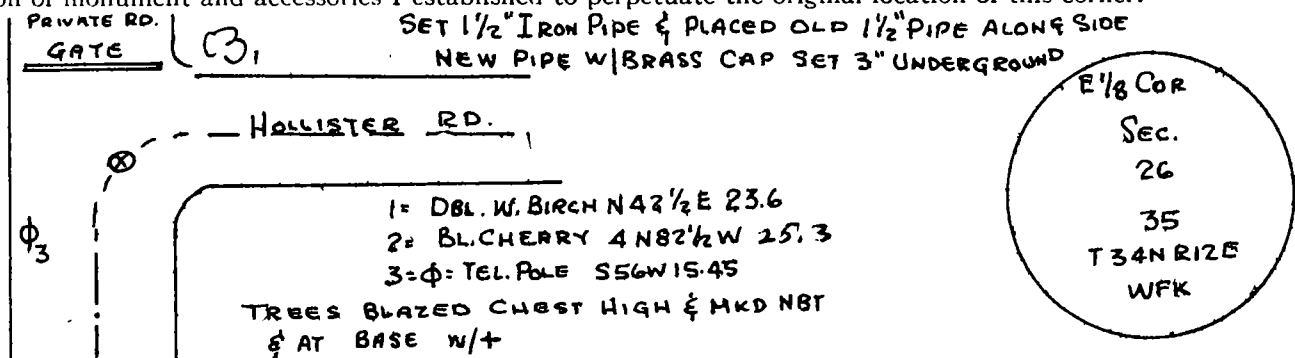
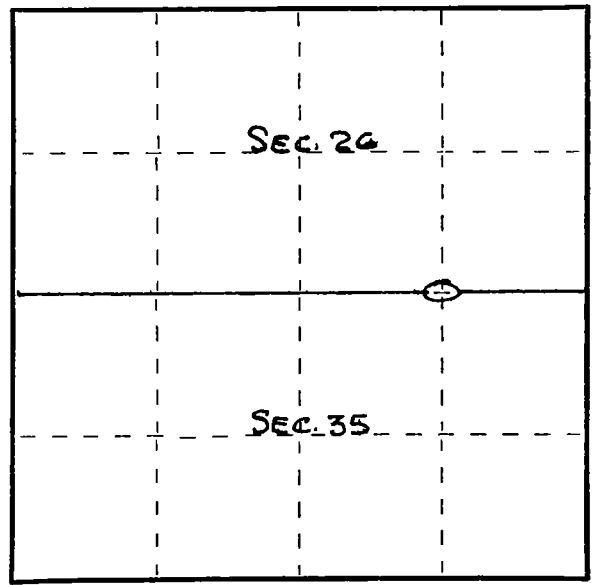

Dated at ELCHO, Wis., this 22ND day of JULY, 1974.

Signature William F. Kelly Title REG. LAND SURVEYOR Registration No. S-1098
(County Surveyor, Registered Land Surveyor, or other duly authorized official)

Office of Register of Deeds, County of _____, I hereby certify that the within instrument was filed in this office for record on the _____ day of _____, 19____ at _____ o'clock _____ M.

(Register of Deeds)

By _____ Deputy

○ = Corner monument restored.

FORM 985 K. C. MILLER CO., MILWAUKEE