

CERTIFIED LAND CORNER RESTORATION

Index No. Q - 20

State of Wisconsin }
County of LANGLADE } ss.

History of original corner establishment:
None.

I, WILLIAM F. KELLY, do hereby certify that on the 21st day of NOVEMBER, 1980, I found evidence of the SE 1/16 corner of SEC. 23 Township 34 North, Range 12 East, Fourth Principal Meridian, as described hereon; and that from this evidence I established a new monument and accessories as described hereon to perpetuate the original location of this corner.

Description of corner evidence found:
CORNER ESTABLISHED FROM CONTROL SURVEY OF SEC 23 T34N - R12E

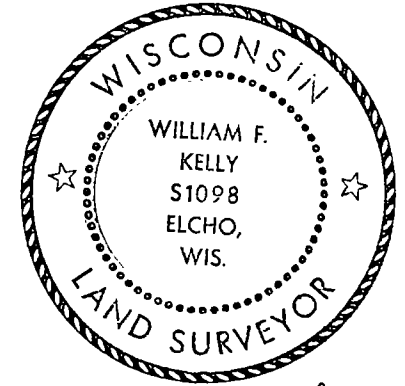

William F. Kelly

Resident witnesses:

SET 1 1/2" x 42" BLACK IRON PIPE WITH BRASS CAP MONUMENT
Description of monument and accessories I established to perpetuate the original location of this corner.

FORM 985 H. C. MILLER CO., MILWAUKEE

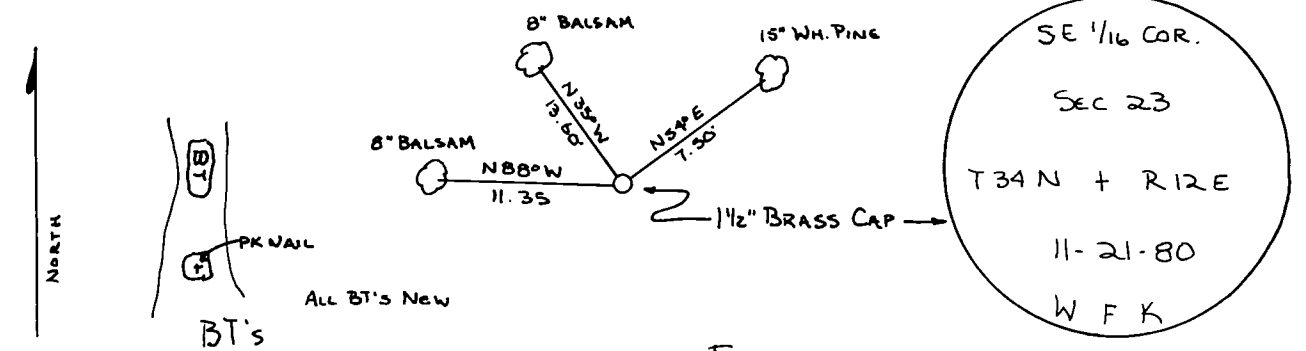
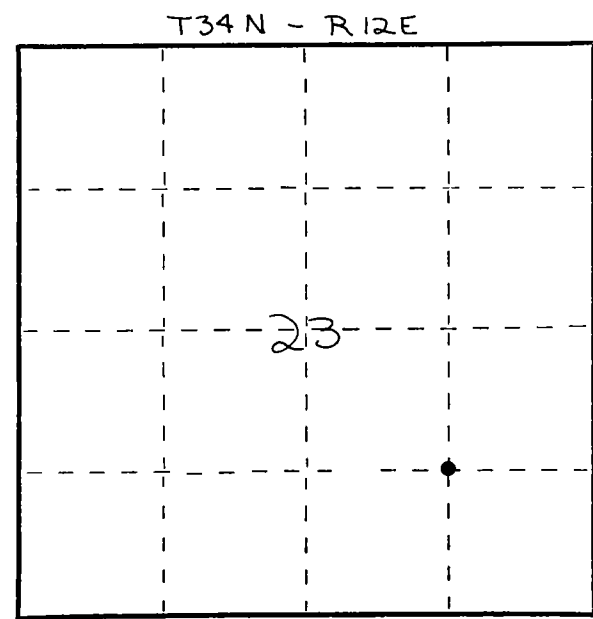

Dated at ELCHO, Wis., this 21st day of NOV, 1980.

Signature: William F. Kelly Title: COUNTY SURVEYOR Registration No. 1098
(County Surveyor, Registered Land Surveyor, or other duly authorized official)

Office of Register of Deeds, County of _____, I hereby certify that the within instrument was filed in this office for record on the _____ day of _____, 19____ at _____ o'clock _____ M.

(Register of Deeds)

By _____ Deputy

○ = Corner monument restored.