

CERTIFIED LAND CORNER RESTORATION

34-12

Index No. R-11

State of Wisconsin }
County of Langlade } ss.

History of original corner establishment:

I Raymond J. Hallisy, do hereby certify that on the 20th day of July, 1968, I found evidence of the N 1/4 corner of Section 28 Township 34, North, Range 12, Fourth Principal Meridian, as described hereon; and that from this evidence I established a new monument and accessories as described hereon to perpetuate the original location of this corner.

Description of corner evidence found:

Found squared stake standing marked 1/4 S

Resident witnesses:

Description of monument and accessories I established to perpetuate the original location of this corner.

Set Brass Cap in cement 3' deep 4" thick and 1 1/2' above ground.

FORM 985 H. C. MILLER CO., MILWAUKEE

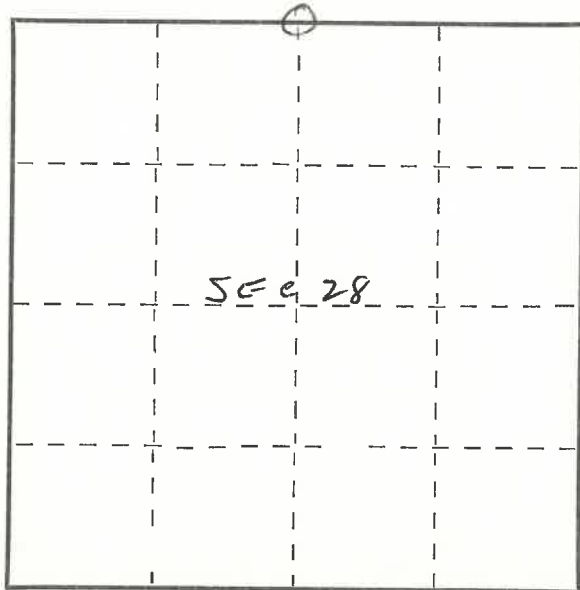

6" BALSAM
N 30 W 4' 10"
SCRIBED BT

B.E.

10" W/BIRCH
N 29 E 8' 8"
SCRIBED BT

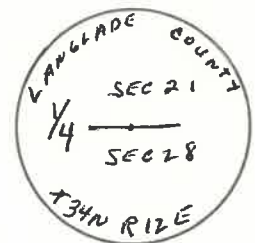

Dated at Antigo, Wis., this 20th day of July, 1968

Signature Raymond J. Hallisy Title Reg Land Surveyor Registration No. A-685
(County Surveyor, Registered Land Surveyor, or other duly authorized official)

Office of Register of Deeds, County of _____, I hereby certify that the within instrument was filed in this office for record on the _____ day of _____, 19____ at _____ o'clock _____ M.

(Register of Deeds)

By _____ Deputy

○ = Corner monument restored.

PLSS field condition report

Date: 4/22/2020 Time of day: 8:15 Am

By: Cody Baumer

Section 28 Town 34 Range 12E
(circle corner location on diagram)



Does the monument appear to be tilted, smashed, uprooted, covered or otherwise damaged by the windstorm?
YES NO

Are any bearing trees broken, uprooted, missing or otherwise damaged by the windstorm? YES NO

FB No longer Present

4341221 0020

TAKE PICTURES

For the first four pictures, do them in this order:

Looking north, looking east, looking south, looking west and, by standing about 6 feet behind the monument, include the monument in each picture.

Then take a picture of the top of the monument, close enough to be able to read what is stamped on the cap. Make sure all pictures are in focus.

R11

R 11 34 12