

CERTIFIED LAND CORNER RESTORATION

34-12

Index No. R-12

State of Wisconsin }
County of Langlade } ss.

I Raymond J. Hallisy, do hereby certify that on the 5th day of July, 1971, I found evidence of the E. 1/16 corner of Section 21 & 28 Township 34, North, Range 12E, Fourth, Principal Meridian, as described hereon; and that from this evidence I established a new monument and accessories as described hereon to perpetuate the original location of this corner.

History of original corner establishment:

Ran survey line west from Section corner 21, 22, 28, & 27 at 40.26 chains fell 0.65 Links north of 1/4 corner between 21 & 28. Set 1/16 corner at 20.13 chain 0.325 Links south of random line.

Description of corner evidence found:

Description of monument and accessories I established to perpetuate the original location of this corner.

Set 2" pipe with brass cap.
BT's to corner
Jack Pine 10" N84W 66 links
Jack Pine 6" N42E 62.5 links
BT's faced at base of tree and scribed BT



Resident witnesses:

FORM 985 H. C. MILLER CO., MILWAUKEE

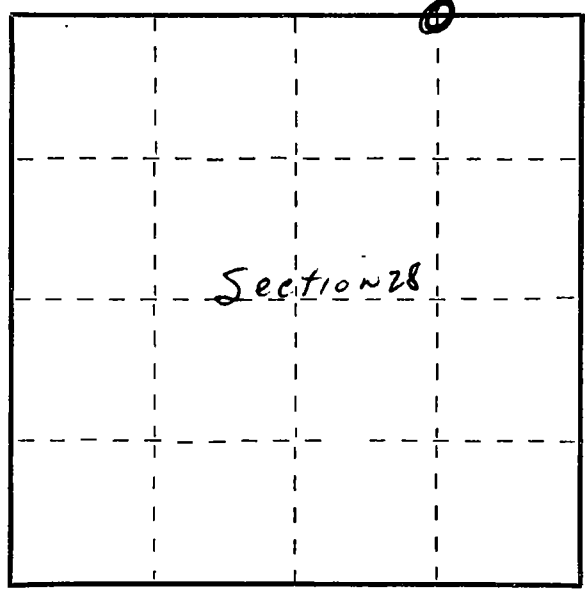

○ = Corner monument restored.

Dated at Antigo, Wis., this 5th day of July, 1971.

Signature: R. J. Hallisy Title: Reg. Land Surveyor Registration No. 685
(County Surveyor, Registered Land Surveyor, or other duly authorized official)

Office of Register of Deeds, County of _____, I hereby certify that the within instrument was filed in this office for record on the _____ day of _____, 19____ at _____ o'clock _____ M.

(Register of Deeds)

By _____ Deputy

CERTIFIED LAND CORNER RESTORATION

34-12
Index No. R-12

State of Wisconsin }
County of Langlade } ss.

History of original corner establishment:

None

I Raymond J. Hallisy, do hereby certify that on the 11th day of October, 19 69, I found evidence of the E 1/16 corner of Section 28 Township T34, North, Range 12E, Fourth, Principal Meridian, as described hereon; and that from this evidence I established a new monument and accessories as described hereon to perpetuate the original location of this corner.

Description of corner evidence found:

Ran transit line from corner to sections 21,22,28 & 27, ran west 40.26 chains and fell .65 lks north of 1/4 corner between Section 21 & 28 bearing used was S88W

Set E 1/16 corner at 20.13 chains .325 south of picket line

Resident witnesses:
.....
.....
.....

Description of monument and accessories I established to perpetuate the original location of this corner.

Set 2" pipe with brass cap
B.T.'s to corner
Jack pine 10" N84W 66lks
Jack pine 6" N42E 62.5lks
B.T.'s faced at base of tree and scribed BT



FORM 985 H. C. MILLER CO., MILWAUKEE

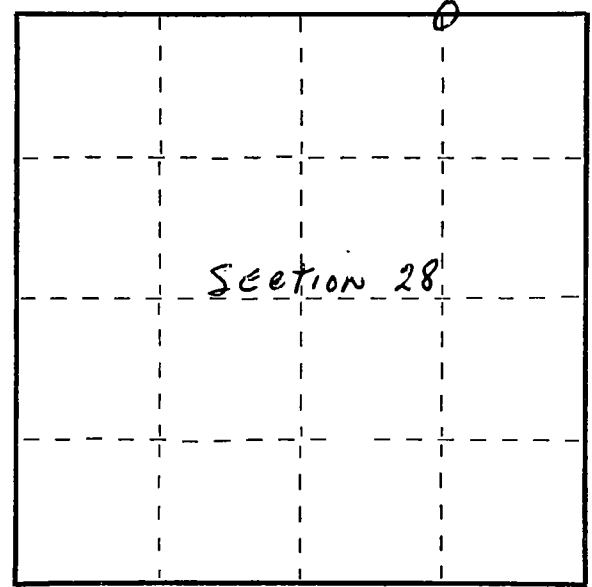

○ = Corner monument restored.

Dated at Antigo, Wis., this 11th day of October, 19 69

Signature Raymond J. Hallisy Title Reg. Land Surveyor Registration No. S-685
(County Surveyor, Registered Land Surveyor, or other duly authorized official)

Office of Register of Deeds, County of _____, I hereby certify that the within instrument was filed in this office for record on the _____ day of _____, 19 _____ at _____ o'clock _____ M.

.....
(Register of Deeds)

By.....Deputy