

CERTIFIED LAND CORNER RESTORATION

Index No. N-5

State of Wisconsin }
County of Langlade } ss.

I Raymond J. Hallisy, do hereby certify that on the 13th day of April, 1980, I found evidence of the Section corner of 17, 18, 19, & 20 Township 34, North, Range 12E, Fourth Principal Meridian, as described hereon; and that from this evidence I established a new monument and accessories as described hereon to perpetuate the original location of this corner.

Resident witnesses:

.....
.....
.....

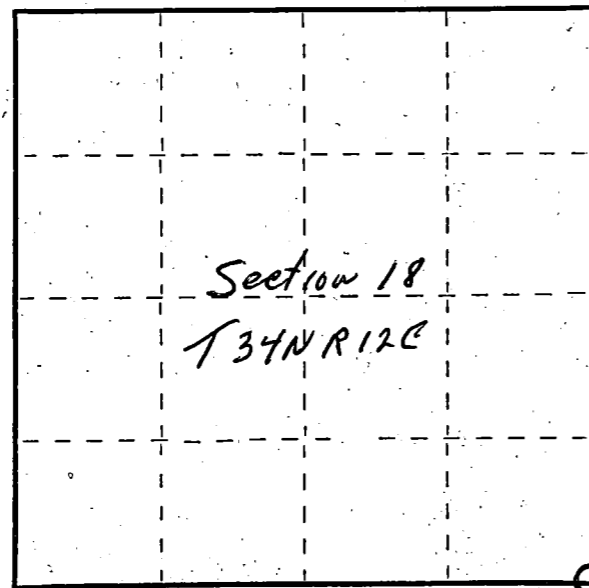

○ = Corner monument restored.

History of original corner establishment:

Corner set by Chas. Borth in the 1930's

Description of corner evidence found:

6" squared post 6' long marked 17, 18, 19, 20

Description of monument and accessories I established to perpetuate the original location of this corner.

Set 2" iron pipe with brass cap alongside post.

New BT's

4"	Black Spruce	S40W	12'8"
5"	Black Spruce	N54W	8'
10"	Jack Pine	N82E	12'5"
7"	Jack Pine	S65E	17'

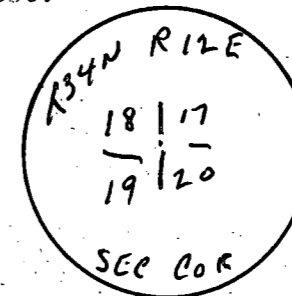

Dated at Antigo, Wis., this 13th day of April, 1980.

Signature Raymond J. Hallisy Title Land Surveyor Registration No. S-685
(County Surveyor, Registered Land Surveyor, or other duly authorized official)

Office of Register of Deeds, County of _____, I hereby certify that the within instrument was filed in this office for record on the _____ day of _____, 19____ at _____ o'clock _____ M.

(Register of Deeds)

By _____ Deputy