

CERTIFIED LAND CORNER RESTORATION

34-12
Index No. M-21

State of Wisconsin }
County of LANGLADE } ss.

History of original corner establishment:

FOUND NO STAKE, SET 1/16 COR MIDWAY BETWEEN 1/4 COR &
SEC COR ON SEC. LINE

CORR. COPY

I ROBERT J. POSS, do hereby
certify that on the 24TH day
of SEPTEMBER, 1971, I found
evidence of the S 1/16 SECTION
corner of SECS 14 & 13
Township 34, North, Range
12 EAST, Fourth, Principal Meridian,
as described hereon; and that from this evidence
I established a new monument and accessories
as described hereon to perpetuate the original
location of this corner.

Description of corner evidence found:

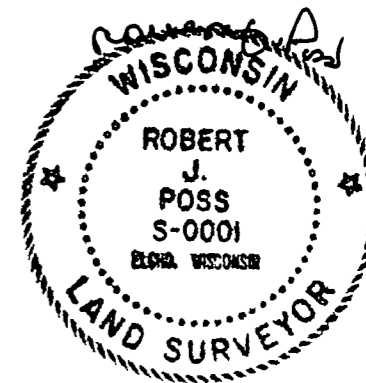

Resident witnesses:

.....
.....
.....

Description of monument and accessories I established to perpetuate the original location of this corner.

SET IRON PIPE 1 1/4" WITH BRASS CAP MKD S 1/16
S 14 SEC 13
T 34 N R 12 E



- 1 = HEMK 16 N 11 1/2 E 11.7
 - 2 = N. PINE 10 S S D E 19.7
 - 3 = N PINE 12 N 77 1/2 W 16.5
- ALL TREES BLAZED & SCRIBED NET

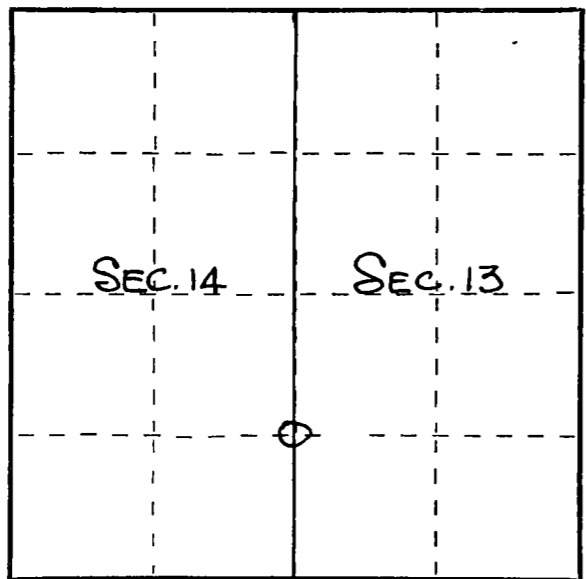

Dated at Ellettsville, Wis., this 29TH day of SEPTEMBER, 1971.

Signature Robert J. Poss Title REG. LAND SURVEYOR Registration No. S-0001
(County Surveyor, Registered Land Surveyor, or other duly authorized official)

Office of Register of Deeds, County of....., I hereby certify that the within
instrument was filed in this office for record on the..... day of....., 19.....
at..... o'clock..... M.

.....
(Register of Deeds)

By..... Deputy

○ = Corner monument restored.

CERTIFIED LAND CORNER RESTORATION

34-12

Index No. M-21

State of Wisconsin }
County of LANGLADE } ss.

History of original corner establishment:

I ROBERT J. POSS, do hereby certify that on the 26TH day of MAY, 1970, I found SET evidence of the S 1/16 corner BETWEEN SECS. 13 & 14 Township 34, North, Range 12 EAST, Fourth, Principal Meridian, as described hereon; and that from this evidence I established a new monument and accessories as described hereon to perpetuate the original location of this corner.

Description of corner evidence found:

DID NOT FIND OLD STAKE - NO BLAZED TREES
TRAVERSE FROM SEC. 13-14 COR. TO 1/4 COR.
SET STAKE AT MID-POINT.

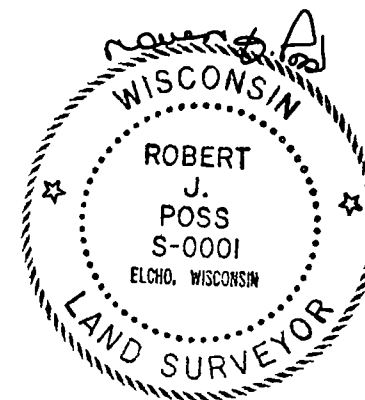

Resident witnesses:

CHAS. GRAVITER

Description of monument and accessories I established to perpetuate the original location of this corner.

SET 1/4" PIPE (IRON) PAINTED ORANGE MKD S 1/16 COR
SEC. 14-13
T 34 N R 12 E

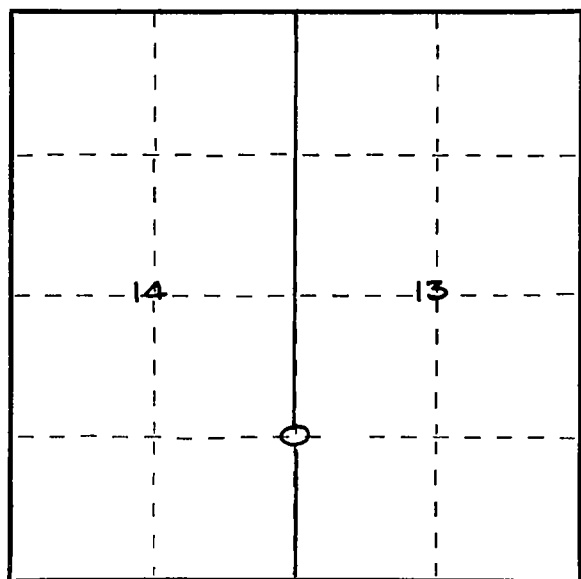

SPRUCE 10 N 89 W 19.7
HEMLOCK 16 N 29 W 12.0
W. PINE 18 N 78 1/2 E 18.0

ALL TREES
BLAZED AT BASE
& CHEST HIGH.
SCRIBED (POOR) NBT

Dated at ELCHO, Wis., this 28TH day of MAY, 1970

Signature Robert J. Poss Title REG. LAND SURVEYOR Registration No. S-0001
(County Surveyor, Registered Land Surveyor, or other duly authorized official)

Office of Register of Deeds, County of _____, I hereby certify that the within instrument was filed in this office for record on the _____ day of _____, 19 _____ at _____ o'clock _____ M.

(Register of Deeds)

By _____ Deputy

○ = Corner monument restored.

FORM 985 H. C. MILLER CO., MILWAUKEE