

CERTIFIED LAND CORNER RESTORATION

Index No. F-17

State of Wisconsin }  
County of LANGLADE } ss.

I William F. Kelly, do hereby certify that on the 16<sup>th</sup> day of SEPT., 1979, I found evidence of the N 1/8 corner of SECT 10 & 11 Township 34, North, Range 12, Fourth Principal Meridian, as described hereon; and that from this evidence I established a new monument and accessories as described hereon to perpetuate the original location of this corner.

Resident witnesses:

.....  
.....  
.....

FORM 985 H. C. MILLER CO., MILWAUKEE

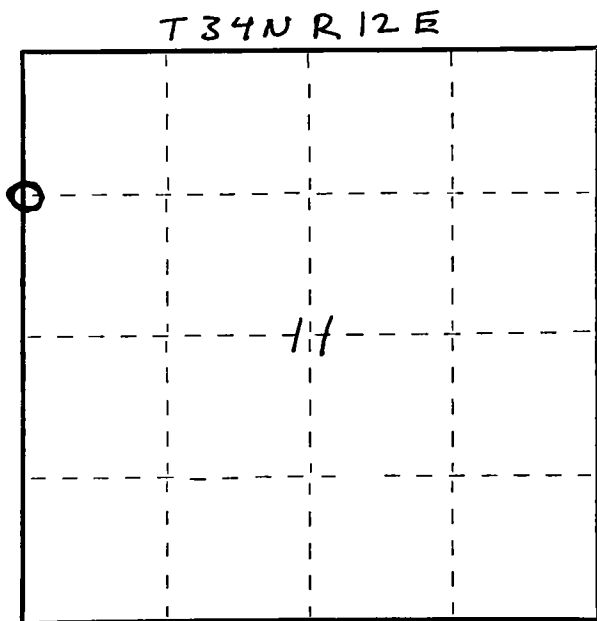

○ = Corner monument restored.

History of original corner establishment:

Description of corner evidence found:

Found remains of old 4x4 scribed post and one old bearing tree

SET 1 1/2 x 42" IP WITH BRASS CAP AND MARKED WITH COR.

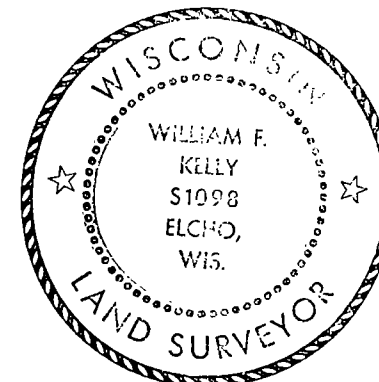

W.F. Kelly

Description of monument and accessories I established to perpetuate the original location of this corner.

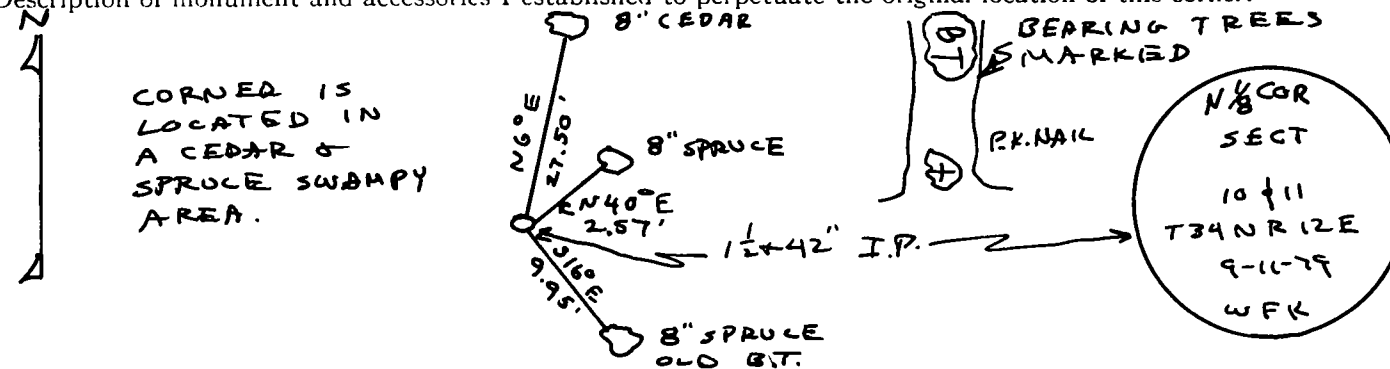

Dated at ELCHO, Wis., this 16<sup>th</sup> day of SEPTEMBER, 1979

Signature William F. Kelly Title COUNTY SURVEYOR Registration No. S-1098  
(County Surveyor, Registered Land Surveyor, or other duly authorized official)

Office of Register of Deeds, County of ....., I hereby certify that the within instrument was filed in this office for record on the ..... day of ....., 19..... at ..... o'clock ..... M.

(Register of Deeds)

By ..... Deputy