

CERTIFIED LAND CORNER RESTORATION

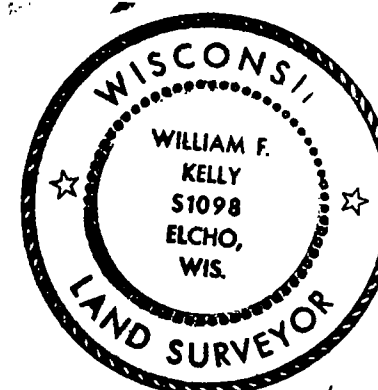

Index No. J-13
34.12

State of Wisconsin }
County of LANGLADE } ss.

History of original corner establishment:
WOOD POST PROBABLY SET BY C. BORTH.

I WILLIAM F. KELLY, do hereby certify that on the 11TH day of MAY, 1976, I found evidence of the SECTION corner of SECTIONS 9, 10, 14, 15 Township 34, North, Range 12E, Fourth Principal Meridian, as described hereon; and that from this evidence I established a new monument and accessories as described hereon to perpetuate the original location of this corner.

Description of corner evidence found:
LOCATED SCRIBED WOOD POST - 8" SQUARE MARKED S9, S10, S16, S15 POST WAS IN A CEDAR AND BALSAM SWAMP AREA. ALSO FOUND AN OLD SCRIBED BEARING TREE. POST WAS PARTIALLY DOWN. BOTTOM POINT OF POST FOUND INTACT.

William F. Kelly 22/6/76

Resident witnesses:

Description of monument and accessories I established to perpetuate the original location of this corner.

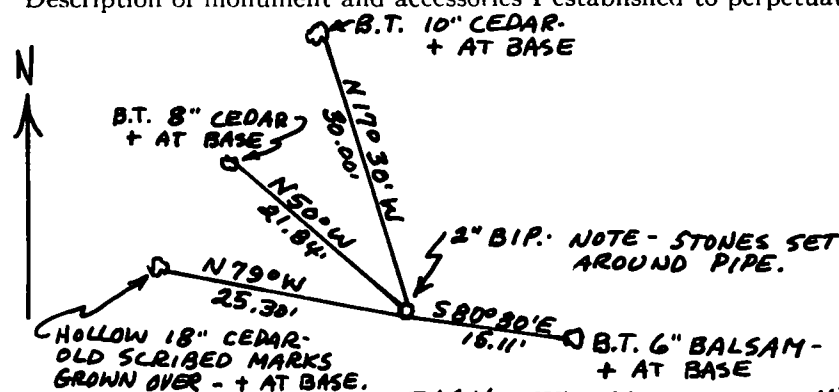

SET A 2" BLACK IRON PIPE WITH BRASS CAP MARKED: MARKED NEW BEARING TREES.

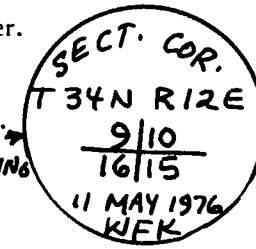

FORM 985 M. C. MILLER CO. MILWAUKEE

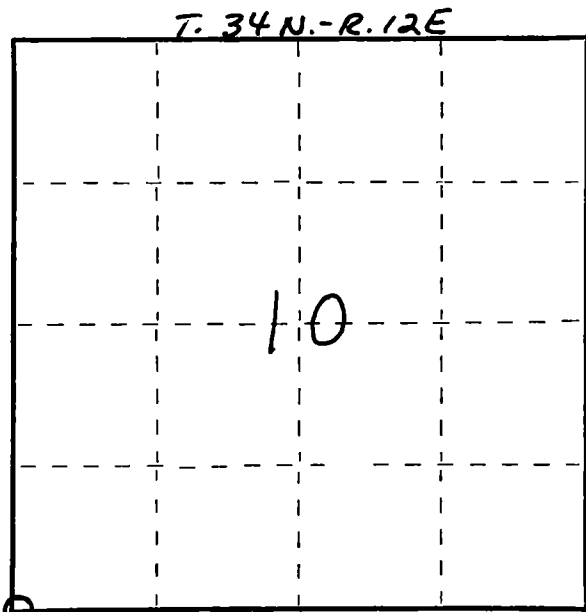

○ = Corner monument restored.

Dated at ELCHO, Wis., this 11TH day of MAY, 1976

Signature William F. Kelly Title REGISTERED LAND SURVEYOR Registration No. 51098
(County Surveyor, Registered Land Surveyor, or other duly authorized official)

Office of Register of Deeds, County of _____, I hereby certify that the within instrument was filed in this office for record on the _____ day of _____, 19____ at _____ o'clock _____ M.

(Register of Deeds)

By _____ Deputy