

CERTIFIED LAND CORNER RESTORATION

Index No. G-9

State of Wisconsin }
County of Lauvade } ss.

I, Raymond Hollisy, do hereby certify that on the 19th day of October, 1974, I found evidence of the 1/4 corner of Sec 8 & 9 Township 34, North, Range 12E, Fourth Principal Meridian, as described hereon; and that from this evidence I established a new monument and accessories as described hereon to perpetuate the original location of this corner.

Resident witnesses:

.....
.....
.....

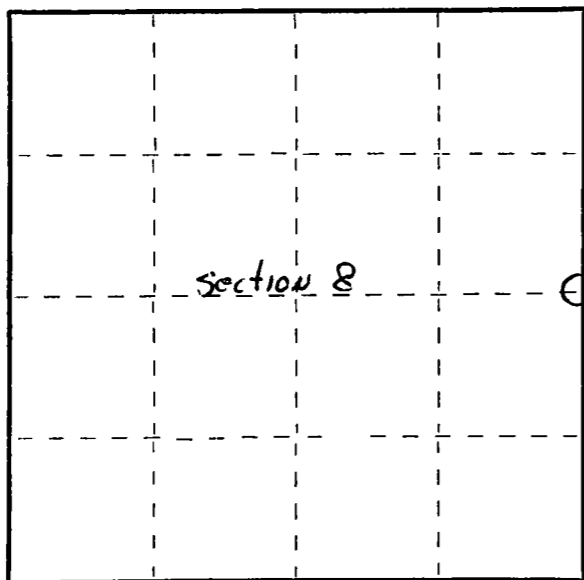

○ = Corner monument restored.

History of original corner establishment:

corner set by C. Berth in 1930s

Description of corner evidence found:

6" squared post 5' high. Rock mound

BT's

16" oak N28E 23 FT

14" Red Maple S26W 21 FT 2 in.

Description of monument and accessories I established to perpetuate the original location of this corner.

Set 2" iron pipe with brass cap

New BT's

8" Hard Maple N26E 17 FT. 6 in.

10" white birch S41E 4 FT. 1 in

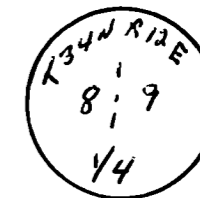

Dated at Ant 190, Wis., this 19th day of October, 1974.

Signature Raymond Hollisy Title Reg Land Surveyor Registration No. 5-685
(County Surveyor, Registered Land Surveyor, or other duly authorized official)

Office of Register of Deeds, County of _____, I hereby certify that the within instrument was filed in this office for record on the _____ day of _____, 19____ at _____ o'clock _____ M.

.....
(Register of Deeds)

By..... Deputy