

CERTIFIED LAND CORNER RESTORATION

Index No. J-7

State of Wisconsin }
County of LANGLADE } ss.

I RAYMOND S. HALLISY, do hereby certify that on the 11 TH day of MAY, 1985, I found evidence of the 1/4 corner of SECTION 8 S 17 Township 34, North, Range 12 E, Fourth Principal Meridian, as described hereon; and that from this evidence I established a new monument and accessories as described hereon to perpetuate the original location of this corner.

Resident witnesses:

.....
.....
.....

History of original corner establishment:

SET BY C. BIRTH IN THE 1930'S

Description of corner evidence found:

6" WOOD POST STANDING
SERIAGO S 1/4 S 8, S 17

Description of monument and accessories I established to perpetuate the original location of this corner.

SET 3" ALUMINUM PIPE WITH CAP
ALONGSIDE POST
NEW BT'S
10" BLACK SPRUCE N 20 W 40.6'
10" WHITE BIRCH N 64 E 5.6'
4" RED MAPLE S 74 W 13.8'
11" BLACK SPRUCE N 50 E 31.6'

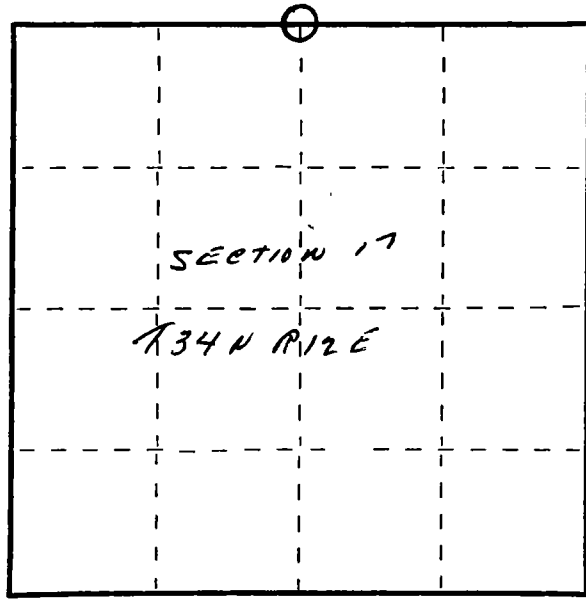
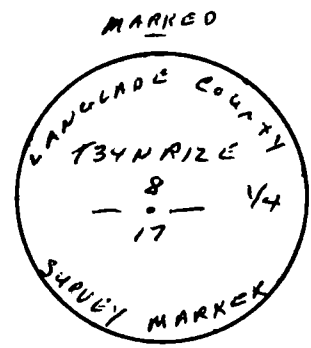

○ = Corner monument restored.

Dated at ANTIGO, Wis., this 11 TH day of MAY, 1985

Signature Raymond S. Hallisy Title LAND SURVEYOR Registration No. S-685
(County Surveyor, Registered Land Surveyor, or other duly authorized official)

Office of Register of Deeds, County of....., I hereby certify that the within instrument was filed in this office for record on the.....day of....., 19..... at.....o'clock..... M.

(Register of Deeds)

By.....Deputy

FORM 985 R. C. MILLER CO., MILWAUKEE