

CERTIFIED LAND CORNER RESTORATION

Index No. G-5

State of Wisconsin }  
County of Lenglade } ss.

History of original corner establishment:

Corner Set by Chas Borth in 1930's

I Raymond Hallisy, do hereby certify that on the 17<sup>th</sup> day of August, 1974, I found evidence of the 7 1/8 corner of 34 Township 12E, North, Range 12E, Fourth Principal Meridian, as described hereon; and that from this evidence I established a new monument and accessories as described hereon to perpetuate the original location of this corner.

Description of corner evidence found:

6' Scribed wood Post  
Large Rock S 18 1/2° E with X on top. 20.9 FT  
Rock mound

Resident witnesses:

Description of monument and accessories I established to perpetuate the original location of this corner.

Set 2" iron pipe with brass cap, Set old hollow post on top  
New BT  
Red Maple 6" N 18° E 10' 7"



FORM 985 H. C. MILLER CO., MILWAUKEE

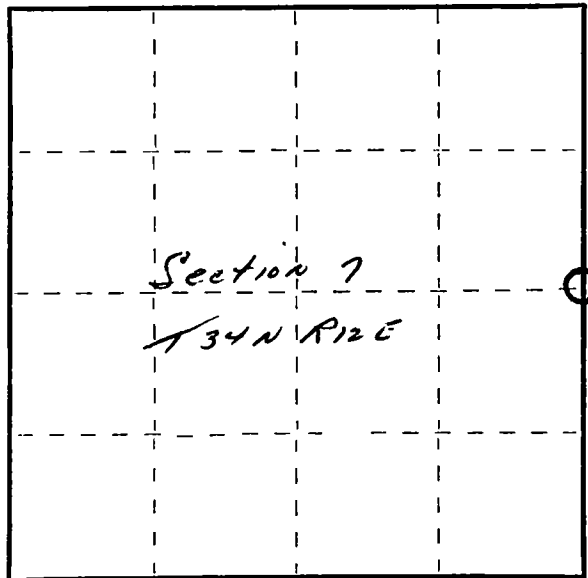

○ = Corner monument restored.

Dated at Antigo, Wis., this 17<sup>th</sup> day of August, 1974.

Signature Raymond Hallisy Title Reg. Land Surveyor Registration No. 5685  
(County Surveyor, Registered Land Surveyor, or other duly authorized official)

Office of Register of Deeds, County of \_\_\_\_\_, I hereby certify that the within instrument was filed in this office for record on the \_\_\_\_\_ day of \_\_\_\_\_, 19\_\_\_\_ at \_\_\_\_\_ o'clock \_\_\_\_\_ M.

(Register of Deeds)

By \_\_\_\_\_ Deputy