

CERTIFIED LAND CORNER RESTORATION

Index No. J-3

State of Wisconsin }
County of Langlade } ss.

I Raymond J. Hallisy, do hereby certify that on the 30th day of October, 19 82, I found evidence of the 1/4 corner of Section 7 & 18 Township 34, North, Range 12E, Fourth Principal Meridian, as described hereon; and that from this evidence I established a new monument and accessories as described hereon to perpetuate the original location of this corner.

Resident witnesses:

.....
.....
.....

FORM 985 M. C. MILLER CO., MILWAUKEE

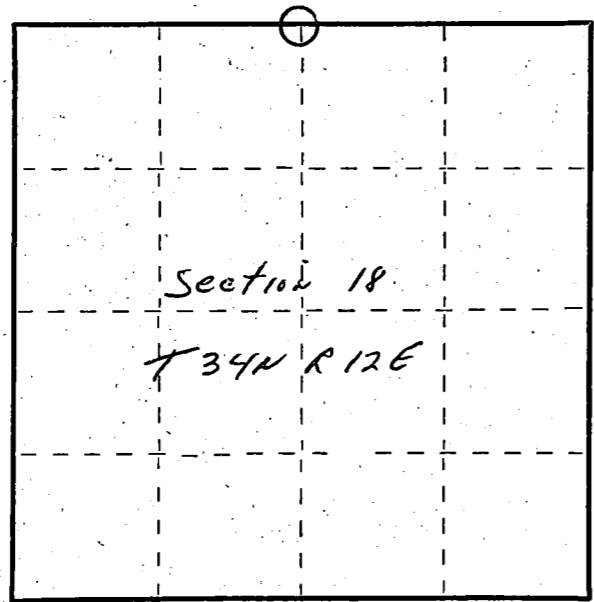

○ = Corner monument restored.

History of original corner establishment:

Corner set by C.W. Borth 1930's

Description of corner evidence found:

6" cedar post standing, marked 1/4S 7, 18

Description of monument and accessories I established to perpetuate the original location of this corner.

Set 2" aluminum pipe with cap.

New BT's

- 6" Spruce S47E 3'
- 6" Red Maple S11E 13.8'
- 12" W/Birch S64W 22'

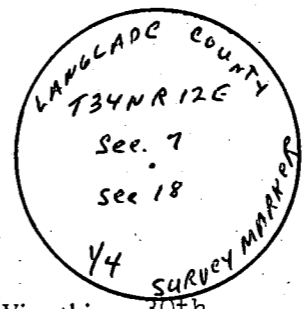

Dated at Antigo, Wis., this 30th day of October, 19 82.

Signature Raymond J. Hallisy Title Land Surveyor Registration No. S-685
(County Surveyor, Registered Land Surveyor, or other duly authorized official)

Office of Register of Deeds, County of _____, I hereby certify that the within instrument was filed in this office for record on the _____ day of _____, 19 _____ at _____ o'clock _____ M.

(Register of Deeds)

By _____ Deputy