

CERTIFIED LAND CORNER RESTORATION

Index No. J-5

State of Wisconsin }
County of Langlade } ss.

I Raymond J. Hallisy, do hereby certify that on the 11th day of May, 1985, I found evidence of the Section corner of 7, 8, 17, 18 Township 34, North, Range 12 East, Fourth Principal Meridian, as described hereon; and that from this evidence I established a new monument and accessories as described hereon to perpetuate the original location of this corner.

Resident witnesses:

.....
.....
.....

History of original corner establishment:

Set By C. Borth in 1930's

Description of corner evidence found:

Squared cedar post
Scribed S 7, 8, 17, 18
old B.T.s
Red oak 18" S53°E 33.6 FT
Red pine 20" N57°W 36.3 FT

Description of monument and accessories I established to perpetuate the original location of this corner.

Set 3" Aluminum pipe with CAP

New B.T.s

Red maple 5" S70°E 16.7 FT
Red maple 9" S36°E 13.4 FT
Red maple 6" N87°W 19.8 FT
White spruce 6" N6°W 25.6 FT

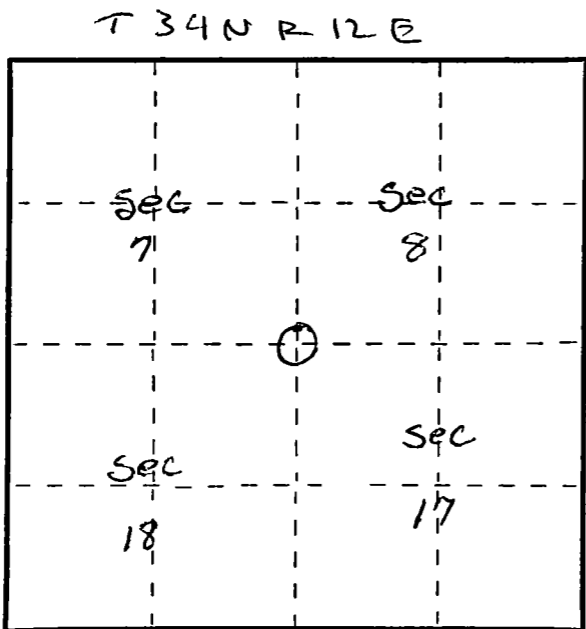
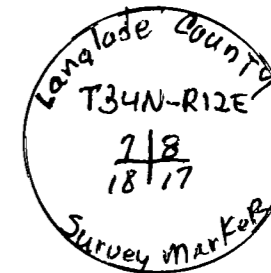

○ = Corner monument restored.

Dated at Antigo, Wis., this 11th day of May, 1985.

Signature Raymond J. Hallisy Title Land Surveyor Registration No. 5-625
(County Surveyor, Registered Land Surveyor, or other duly authorized official)

Office of Register of Deeds, County of....., I hereby certify that the within instrument was filed in this office for record on the.....day of....., 19..... at..... o'clock..... M.

.....
(Register of Deeds)

By.....Deputy

FORM 985 H. C. MILLER CO., MILWAUKEE